

CHEVROLET SILVERADO

# 2020 CHASSIS CAB



**4500HD**

**5500HD**

**6500HD**





  
**TECHNOLOGY**

pp. 8-9

  
**POWERTRAIN**

pp. 4-5

  
**INTERIOR**

pp. 10-11

  
**UPFIT**

pp. 14-19

  
**SERVICEABILITY**

pp. 6-7

  
**USABILITY**

pp. 12-13

  
**SPECS**

pp. 22-23

**We're in the  
front to back  
productivity  
business.**

 DURAMAX®  
**6.6L V8**  
Turbo-Diesel Engine

 ALLISON®  
**6-SPEED**  
Close-Ratio Automatic Transmission  
w/Double Overdrive



## PROVEN POWER

Getting the job done takes power, strength and dependability. That's why Silverado Chassis Cab is built with loads of all three. The Duramax 6.6L Turbo-Diesel V8 engine has been optimized to deliver brute strength and legendary reliability that lives up to the Duramax name. Putting power to the ground are a variety of Allison Transmission options suited to the needs of your business, each featuring durability you can depend on day in and day out. You built your business to be a powerhouse. We built a truck you can count on to make it happen.

Shown throughout with equipment from independent suppliers which is not covered by the GM New Vehicle Limited Warranty. GM is not responsible for the safety or quality of independent supplier alterations.



STANDARD

**700 LB.-FT.**

Torque @ 1600 RPM



STANDARD

**350 HP**

@ 2700 RPM



# NO TIME FOR DOWNTIME

Keeping your trucks on the road is a crucial part of keeping your business on the road. The Silverado Chassis Cab was built with that in mind. From the design of the hood to the placement of vital components, everything is designed to make maintenance as painless as possible.



## TILT FORWARD HOOD

Lightweight fiberglass tilt engine cover with integrated hand grips for easy access and a built-in lock to keep it securely open.



## CONVENIENT DEF TANK

With the DEF tank located low, outside of the hood and away from the fuel tank, drivers can fill it easily and avoid confusion.



## BATTERY BOX

Easy to reach battery box with available auxiliary jump-start stud located right below the driver side of the cab.



 WHEEL CUT  
**50°**

Up to 50 degrees of wheel cut allows for easy access to the engine bay and can save time on maintenance.

# A MORE CONNECTED CAB

Help keep your fleet connected and on top of their tasks thanks to the advanced connectivity and mobile office features available in the Silverado Chassis Cab that can help your drivers stay focused on the road ahead. With built-in telematics features integrated into the vehicle, your fleet can be equipped with the brains to match its brawn.



## 8" DIAGONAL TOUCH-SCREEN

Without handling their phones, drivers can access calls, alerts and notifications on the available Chevrolet Infotainment System<sup>1</sup> with 8-inch diagonal color touch-screen.

## Apple CarPlay<sup>®2</sup> & ANDROID AUTO™<sup>3</sup>

Seamless smartphone integration puts contacts, maps, messages and more at your drivers' fingertips with available Apple CarPlay and Android Auto compatibility.

## WIRELESS CHARGING<sup>4</sup>

Drivers and crew can use and charge their devices without cords cluttering the cab anytime the vehicle is running, thanks to available wireless charging.

<sup>1</sup>Functionality varies by model. Full functionality requires compatible Bluetooth and smartphone. Some devices require USB connectivity. <sup>2</sup>Vehicle user interface is a product of Apple and its terms and privacy statements apply. Requires compatible iPhone and data plan rates apply. Apple CarPlay, Siri, iPhone and iTunes are trademarks of Apple Inc., registered in the U.S. and other countries. <sup>3</sup>Vehicle user interface is a product of Google, and its terms and privacy statements apply. Requires the Android Auto app on Google Play and an Android compatible smartphone running Android™ 5.0 Lollipop or higher. Data plan rates apply. Android Auto is a trademark of Google LLC. <sup>4</sup>The system wirelessly charges one PMA- or Qi-compatible mobile device. Some phones have built-in wireless charging technology and others require a special adaptor/back cover. To check for phone or other device compatibility, see [my.chevrolet.com/learn](http://my.chevrolet.com/learn) or consult your carrier.



## AUXILIARY SWITCHES

A total of 13\* available conveniently located, factory-installed switches—with up to 10 customizable—can help reduce upfit time and costs.

\*6 switches available late summer 2019.

## 110-VOLT OUTLET

Keep devices, tools and batteries fully charged with the available 110-volt outlet.



Hands-free calling and communication



Built-in Wi-Fi® Hotspot<sup>6</sup>



Helps drivers safely navigate in Reverse

*Shipped loose for upfitter installation.*



## ONSTAR®<sup>8</sup>

Assist drivers during a crisis<sup>9</sup>, deliver Turn-by-Turn directions<sup>9</sup> and team up with local law enforcement to help recover lost or stolen vehicles with the safety and security of available factory-installed OnStar hardware.

## COMMERCIAL LINK™<sup>10</sup>

Using the embedded OnStar® hardware, you can easily monitor your fleet's vital statistics such as speed, location, fuel levels and more with Commercial Link's available built-in telematics solutions.

<sup>5</sup>Go to <https://my.chevrolet.com/learnAbout/bluetooth> to find out which phones are compatible with the vehicle. <sup>6</sup>Service varies with conditions and location. Requires active services and paid data plan offered by AT&T. See [onstar.com](http://onstar.com) for details and limitations. <sup>7</sup>Safety or driver assistance features are no substitute for the driver's responsibility to operate the vehicle in a safe manner. The driver should remain attentive to traffic, surroundings and road conditions at all times. Visibility, weather, and road conditions may affect feature performance. Read the vehicle's Owner's Manual for more important feature limitations and information. <sup>8</sup>See [onstar.com](http://onstar.com) for details and limitations. Services vary by model. Service plan required. <sup>9</sup>Connected vehicle services vary by vehicle model and require working electrical system, cell reception and GPS signal. Requires active service plan. OnStar links to emergency services. See [onstar.com](http://onstar.com) for details and limitations. <sup>10</sup>Available in select 2015 model year and newer GM vehicles (excludes Spark EV, Bolt EV, Volt, City Express Vans and Low Cab Forward Trucks). Requires active service plan. Fees, Services, and availability subject to change without notice. Applicable taxes not included. Does not include emergency or security services. See [gmcommercialink.com](http://gmcommercialink.com) for details and limitations. User terms apply.

# CREW COMFORTS

Building off of the comfort of the Silverado HD cab and interior, Silverado Chassis Cab is focused on making drivers and crew confident and comfortable while on the job. Available in either Regular Cab or Crew Cab with features such as easy-to-reach knobs, buttons and interfaces, inlaid doors, available Remote Start and an available center console featuring four USB ports<sup>1</sup>, a 110-volt outlet and integrated file storage, Silverado Chassis Cab blends comfort with capability.



## CROWD CONTROL

When the job calls for a bigger crew, Silverado Chassis Cab can move up to six people with its customizable interior featuring high-wear cloth seats and an available 10-way power driver seat.

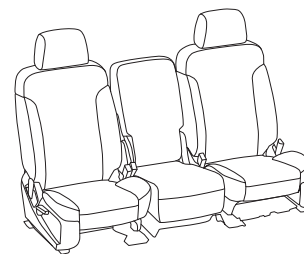

**40/20/40 BENCH SEAT**

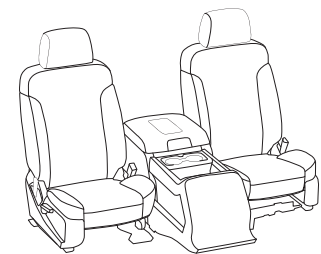

**BUCKET SEATS**

<sup>1</sup>Not compatible with all devices.

 STANDARD  
**6 AIRBAGS**

Silverado Chassis Cab features frontal, seat-mounted side-impact and head-curtain airbags

## SAFETY IS JOB NO. 1

In addition to single-stage frontal airbags for driver and outboard passenger, Silverado Chassis Cab offers seat-mounted side-impact airbags for driver and front outboard passenger as well as head-curtain airbags for outboard seating positions in both Regular Cab and Crew Cab configurations!

A NOTE ON CHILD SAFETY: Always use seat belts and the correct child restraint for your child's age and size, even with airbags. Even in vehicles equipped with the Passenger Sensing System, children are safer when properly secured in a rear seat in the appropriate infant, child or booster seat. Never place a rear-facing infant restraint in the front seat of any vehicle equipped with an active frontal airbag. See your vehicle Owner's Manual and child safety seat instructions for more safety information.

## AVAILABLE LOCKING REAR DIFFERENTIAL

Available locking rear differential\* provides stability when vehicle is parked and aerial is in use.

\*Available late summer 2019.





## IN COMMAND

Silverado Chassis Cab is built to deliver productivity for your business and it's also built with your drivers in mind. An impressive turning radius combined with driver-focused design features means drivers can easily maneuver Silverado Chassis Cab's enormous muscle.

### A. EXTERIOR MIRRORS

Two side mirror options including power-adjustable, heated trailering mirrors with integrated turn signals to help monitor wide loads.

### B. ASSIST STEPS

Standard self-cleaning assist steps available in black steel or aluminum can help your drivers and crews easily access the cab.

### C. HOOD DESIGN

The downward sloping design of the hood gives drivers an elevated perspective to help with visibility on the road and the job site.



## MANEUVER WITH CONTROL

A wheel cut of up to 50 degrees, available locking rear differential and an optional front stabilizer bar gives Silverado Chassis Cab handling and traction that matches its extraordinary strength.

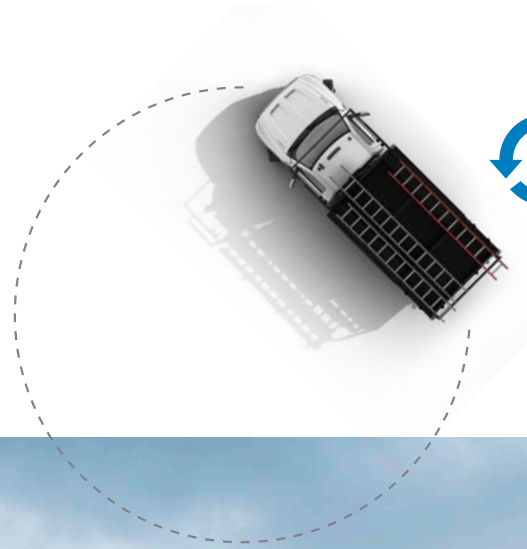

TURNING DIAMETER  
**41.2 FT.\***

\*2020 Chevrolet Silverado  
Medium Duty Regular Cab  
2WD with 141 inch  
wheelbase.





**7**  
**CAB-TO-AXLE**  
Options

**10**  
**WHEELBASE**  
Options

**5**  
**AXLE-TO-END-  
OF-FRAME**  
Options

# STRENGTH YOU CAN BUILD ON

With a frame engineered and tested specifically for medium-duty use, Silverado Chassis Cab features a solid straight-frame design with a clean back of cab that can make the upfit process simple and efficient. When combined with a variety of wheelbase, axle and cab-to-axle options, Silverado Chassis Cab can be tailored to whatever work you put in front of it.



## ADDED DURABILITY

Huck® bolt fasteners provide superior durability, while a class-exclusive frame assembly and paint process offer an extra level of protection from corrosion.

## FLEXIBLE

A variety of exhaust routing options and through-the-frame fuel fill, as well as multiple fuel tank configurations, accommodate the needs of virtually any upfit.

## CLEAN TOP OF FRAME

Single-piece frame rails with no welds or brackets and a clean top of rail allow for optimized upfit integration.



MAX GVWR<sup>1</sup>  
**23,500 LBS.**



MAX PAYLOAD<sup>2</sup>  
**15,940 LBS.**

<sup>1</sup>Gross Vehicle Weight Rating (GVWR). When properly equipped; includes weight of vehicle, passengers, cargo and equipment. <sup>2</sup>These maximum payload ratings are intended for comparison purposes only. Before you buy a vehicle or use it to haul people or cargo, carefully review the Vehicle Loading section of the Owner's Manual and check the carrying capacity of your specific vehicle on the label on the inside of the driver door jamb.

# SMOOTH THINGS OVER

For vehicles that require a more compliant ride, an available factory-installed rear air suspension creates a smoother ride for drivers, crew and cargo while also giving Silverado Chassis Cab the ability to adjust rear load height for easy loading and unloading.



## AVAILABLE EMERGENCY SERVICE PACKAGE

Emergency Service Package with dual alternators, upfitter box switch bank, exhaust brake, backup alarm and end of cab wiring provisions. An available high-idle switch provides power for auxiliary equipment while parked.



## AVAILABLE FACTORY-INSTALLED **REAR AIR SUSPENSION**

With air compressor accessory drive.  
Available with heated air dryer.





## VERSATILE PLATFORM

The solid, straight-frame design with a variety of wheelbase and axle-to-end-of-frame options enables Silverado Chassis Cab to accommodate upfits up to 24' in length, making it ideal for rollback upfits.



#### AVAILABLE SNOW PLOW PACKAGE

Snow Plow Prep Package with auxiliary harness for headlamps and turn signals, factory-installed mounting locations built into the frame, 220-amp alternator, and provision for cab roof mounted lamp/beacon.

## BUILT FOR THE EXTREMES

Validated in extreme heat and bitter cold, Silverado Chassis Cab can be configured for use in the harshest environments. The available PTO gives your fleet the capability to power auxiliary equipment while the available trailer brake controller and standard heavy-duty 4-channel ABS brake system help drivers maintain control while towing heavy cargo. When getting to the job site is the hardest part of the job, features such as traction control, 4-wheel drive, transfer case skid plate, available limited slip rear differential and recovery hooks<sup>1</sup> can help your crews get the job done.

<sup>1</sup>To avoid the risk of injury, never use Recovery Hooks to tow a vehicle. For more information, see the Recovery Hooks section of your Owner's Manual.

# ENDLESS POSSIBILITIES

From dump trucks to rollbacks and snow plows to ambulance bodies, Silverado Chassis Cab is the ideal platform for whatever your fleet is counting on to finish the job.



**ROLLBACK**



**BUCKET**



**DUMP BODY**



**STAKE BODY**



**SERVICE BODY**



**AMBULANCE**



**CONTRACTOR BODY**



**KUV**



**BOX**



**PLOW & SPREADER**

Shown with equipment from independent suppliers which is not covered by the GM New Vehicle Limited Warranty. GM is not responsible for the safety or quality of independent supplier alterations.



**FROM THE FAMILY OF THE  
MOST DEPENDABLE,  
LONGEST-LASTING FULL-SIZE  
PICKUPS ON THE ROAD.<sup>1</sup>**

<sup>1</sup>Dependability based on longevity: 1987-July 2018 full-size pickup registrations.



Shown with equipment from independent suppliers which is not covered by the GM New Vehicle Limited Warranty. GM is not responsible for the safety or quality of independent supplier alterations.

# SPECS

## FEATURES

	WT	LT
Air Conditioning, Single Zone	S	S
4.2" Color Display	S	N/A
7" Diagonal Color Display <sup>1</sup>	A	N/A
8" Diagonal Color Display <sup>1</sup>	N/A	S
Navigation <sup>2</sup>	N/A	A
USB Port	S	S
SiriusXM® Satellite Radio <sup>3</sup>	A	S
Bluetooth <sup>4</sup>	A	S
Cruise Control	S	S
Power Door Locks	S	S
Interior		
Remote Keyless Entry	A	S
OnStar <sup>5</sup>	A	S
4G LTE Wi-Fi <sup>6</sup>	A	A
Rear Vision Camera <sup>7</sup>	A	A
40/20/40 Vinyl Front Seat	S	N/A
40/20/40 Cloth Front Seat	A	S
Bucket Seats	N/A	A
Heated Seats	N/A	A
Leather-Wrapped Steering Wheel	N/A	S
Steering Wheel Audio Controls	N/A	S
Remote Start	N/A	A
Exterior		
Black Front Bumper	S	S
Chrome Front Bumper	A	A
Black Door Handles	S	S
Chrome Door Handles	A	A
Fog Lamps	A	A
Black Grille	S	S
Chrome Grille	A	A
Manual-Folding Mirrors	S	S
Heated Power-Adjustable Mirrors	A	S
Chrome Mirror Caps	A	A
Black 19.5" Steel Wheels	S	S
Aluminum 19.5" Wheels	A	A

## STANDARD FEATURES

Duramax 6.6L Turbo-Diesel Engine
Allison Transmission
Airbags <sup>8</sup>
150-Amp Alternator
Batteries, Heavy-Duty Dual 1100 CCA
Heavy-Duty Hydraulic Brakes
Rear-Mounted 40-Gallon Fuel Tank
16,500 lbs. GVWR
4.10 Rear Axle Ratio (2WD)
4.30 Rear Axle Ratio (4WD)
141" Wheelbase (2WD Reg Cab), 60" CA
165" Wheelbase (4WD Reg Cab), 84" CA
175" Wheelbase (Crew Cab), 60" CA
49" Axle-to-End-of-Frame Length
7,000 lb. Front Axle (2WD)
7,500 lb. Front Axle (4WD)
7,000 lb. Front Suspension (2WD)
7,500 lb. Front Suspension (4WD)
10,000 lb. Rear Axle (2WD)
11,000 lb. Rear Axle (4WD)
11,000 lb. Rear Suspension
Grille Guard Screen (Insect Protection)

A - Available  
N/A - Not Available  
S - Standard

## OTHER KEY AVAILABLE FEATURES

Locking Rear Differential
Limited Slip Rear Differential
Air Compressor Accessory Drive
Air Dryer, Heated
220-Amp Alternator
Dual Alternators 150-Amp and 220-Amp
Batteries, Dual 1300 CCA
Batteries, Triple 2250 CCA
Battery Jump-Start Stud
Exhaust Brake
Front-Mounted 25-Gallon Fuel Tank
Dual Front and Rear Fuel Tanks, 65-Gallon Total
Front Stabilizer Bar
Suspension Air Control Valve (2WD)
Trailer Brake Controller
Trailer Provisions/Wiring Harness
Power Take Off (PTO)
Transfer Case Skid Plate (4WD)
Engine Block Heater
Electrical Provisions Rear of Cab
Electrical Provisions Rear of Frame
Recovery Hooks <sup>9</sup>
Color-Keyed Fender Extensions
Grille Guard Screen (Stone Protection)
Backup Alarm
Seat Belts, Orange Front Outboard
Seat Belts, Red Front Outboard

## DRIVETRAIN OPTIONS

MODEL	STANDARD ENGINE	STANDARD HP @ RPM/LB.-FT. TORQUE @ RPM
SILVERADO MEDIUM-DUTY CHASSIS CAB	Duramax® 6.6L Turbo-Diesel V8	350 @ 2700/700 @ 1600

## FRAME OPTIONS

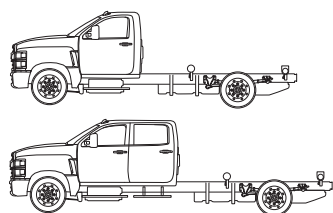

CAB CONFIGURATION	CAB-TO-AXLE LENGTH/WHEELBASE – AVAILABLE AXLE-TO-END-OF-FRAME LENGTH (IN INCHES)			
SILVERADO REGULAR CAB CHASSIS CAB	60"/141" (2WD) – 49" (2WD)	84"/165" – 49", 63"	108"/189" – 49", 63", 75"	120"/201" – 49", 63", 75"
SILVERADO CREW CAB CHASSIS CAB	138"/219" – 75"	150"/231" – 91"	162"/243" – 83"	
SILVERADO CREW CAB CHASSIS CAB	60"/175" – 49"	84"/199" – 49", 63"	120"/235" – 75"	

<sup>1</sup>Functionality varies by model. Full functionality requires compatible Bluetooth smartphone and USB connectivity for some devices. <sup>2</sup>Map coverage available in the United States, the U.S. Virgin Islands, Puerto Rico, and Canada. <sup>3</sup>If you decide to continue service after your trial, your selected subscription plan will automatically renew thereafter. You will be charged at then-current rates. Fees and taxes apply. To cancel you must call SiriusXM at 1-866-635-2349. See SiriusXM Customer Agreement for complete terms at [siriusxm.com](http://siriusxm.com). All fees and programming subject to change. ©2019 Sirius XM Radio Inc. All rights reserved. <sup>4</sup>Go to <https://my.chevrolet.com/learnAbout/bluetooth> to find out which phones are compatible with the vehicle. <sup>5</sup>See [onstar.com](http://onstar.com) for details and limitations. Services vary by model. Service plan required. <sup>6</sup>Service varies with conditions and location. Requires active services and paid data plan offered by AT&T. See [onstar.com](http://onstar.com) for details and limitations. <sup>7</sup>Read the vehicle's Owner's Manual for important safety and driver assistance feature limitations and information. <sup>8</sup>A NOTE ON CHILD SAFETY: Always use seat belts and the correct child restraint for your child's age and size, even with airbags. Even in vehicles equipped with the Passenger Sensing System, children are safer when properly secured in a rear seat in the appropriate infant, child or booster seat. Never place a rear-facing infant restraint in the front seat of any vehicle equipped with an active frontal airbag. See your vehicle Owner's Manual and child safety seat instructions for more safety information. <sup>9</sup>To avoid the risk of injury, never use Recovery Hooks to tow a vehicle. For more information, see the Recovery Hooks section of your Owner's Manual.



## REGULAR CAB — SEATING FOR UP TO 3

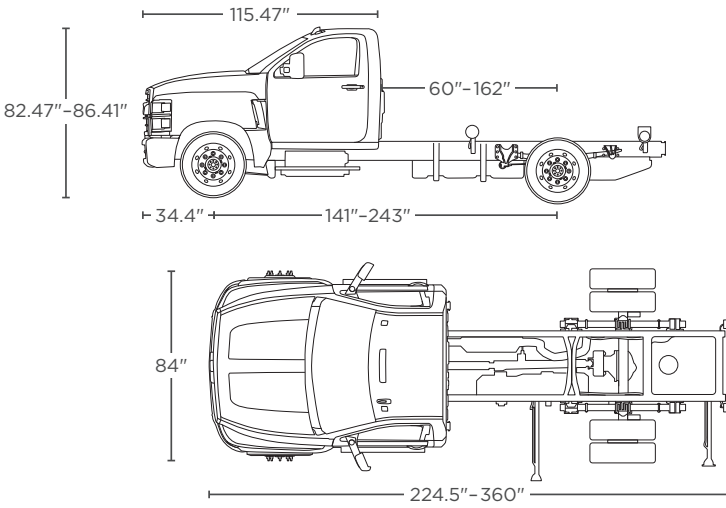

## CREW CAB — SEATING FOR UP TO 6

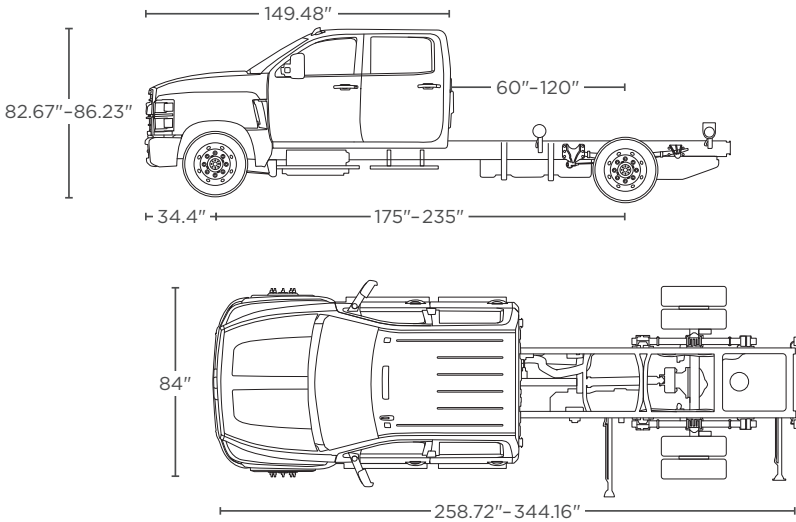

TO LEARN MORE VISIT  
[gmfleet.com/chassiscab](https://gmfleet.com/chassiscab)



