

**NEW**

**FORD V8**

**F250 TRUCKS**



Toughest line of Ford trucks yet

**FORD**  
**F250**  
TRUCKS

VERSATILE, EASY TO HANDLE, WITH  
PROVEN V8 MONEY-MAKING POWER

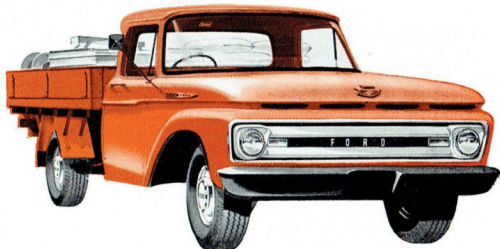

Big power and big torque in this well-proven 292 series Ford V8 engine — plus all of Ford's famous short-stroke economy and long life!

The proven big-muscle work capacity of this short-stroke V8, combined with big power and thrift, make it the most efficient unit in the field. You get fullest benefit of modern short-stroke design. Shorter piston travel, slower piston speeds, and higher compression ratio, develops high horsepower and torque with less engine effort and wear. There's more usable power for every gallon of fuel and longer engine life. Net maximum B.H.P. is 146 at 3,800 r.p.m., and the high net torque of 254 lbs./ft. is obtained at the low revolutionary rate from 1,900-2,400 r.p.m.

This 292 cubic inch V8 engine has a high

8.0:1 compression ratio built to keep "new engine" efficiency at its peak. By combining short-stroke design with large cylinder bores, internal friction and heat losses are reduced, usable power and economy are increased. The result? Greater operating efficiency. Large diameter cylinder bores also permit greater diameter valves and therefore excellent breathing characteristics. The 5-bearing crankshaft material provides great rigidity and stability to withstand the toughest truck operations. Valve guides are integrally cast as part of the cylinder heads. They are superior to the usual inserts, with better heat transfer and large valve life.

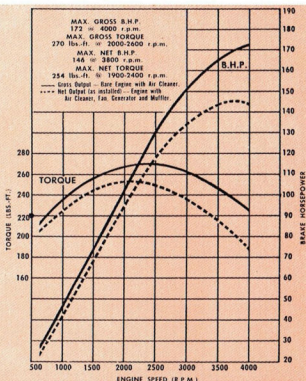
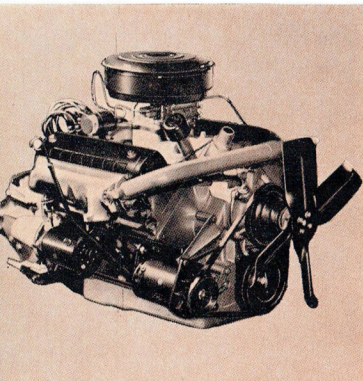

12,000-MILE, 12-MONTH  
(whichever comes first)  
**WARRANTY**  
ON ALL FORD TRUCKS  
(excluding normal maintenance parts and service)

Tough, all-new chassis has extra strength where it counts.

Ford V8 F-250's sturdy new chassis provides extra strength and payload capacity where it counts; to get more work done with less expense. Durable brakes, springs, frame and axles all have the reserve capacity to stand up in hard service. Ford have been builders of tough, hardworking trucks for many years—and this is the toughest line of Ford trucks yet!

ABRIDGED SPECIFICATIONS

Wheelbase	Max. Side Rail Section	Section Modulus
122"	6.0" x 2.25" x 0.19"	3.34

An "12" be...  
For ext...  
con...  
aga...  
this...  
only...  
mem...  
ber...  
pri...

**1. RADIATOR** has soldered lock-seam joint construction and thicker tank and header walls for strength and durability. Independent mounting system prevents transfer of road shocks through sheet metal and greatly extends radiator life.

**2. SERVICE BRAKES** have the capacity and lining area to control F-250's rated load. They are of heavy-duty construction to withstand hard, constant use with maximum efficiency.

**3. FRONT SPRINGS** give a much smoother ride empty or loaded. At the front end, a full loop of the main leaf and half wrap of the second leaf increases spring reliability and provides added safety.

**4. DROP FRAME** in cab mounting area allows  $1\frac{1}{2}$  inches less step height for easier entry into cab, and provides a lower cab silhouette.

**5. REAR SPRINGS** are a full 4 inches longer and  $\frac{1}{2}$  inch wider for improved riding characteristics. They are sturdier, and of heavier rated capacity.

Another 'First' from Ford to put you first: 12/12 Warranty" gives a big new owner-benefit to all F-250 users.

Ford V8 Trucks give you broader warranty—extended to 12,000 miles or 12 months, whichever comes first. Every Ford V8 Truck is warranted against defects in materials and workmanship for a new extended period. Owners are responsible only for normal maintenance and routine replacement of maintenance items. This big extra owner-benefit is provided without any increase in the low prices of Ford V8 Trucks.

## 6. BIGGER, STRONGER

**FRAME** with bigger side rails on 122 inch wheelbase models to give more frame rigidity for longer frame, cab and body durability. Stronger parallel ladder-type frame construction features heavy gauge channel side members and flanged "U"-type crossmembers. Frames are of S.A.E. standard "X" to facilitate mounting of standard or custombuilt bodies.

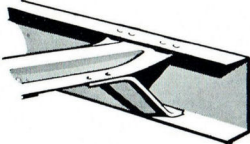

## 7. NEW CAB MOUNTINGS.

F-250's new system of rubber-cushioned 3-point cab-mounting provides a better ride, insulates the cab against frame stresses and vibration, reducing sheet metal strains. The system accordingly increases cab-life and improves the operator's comfort.

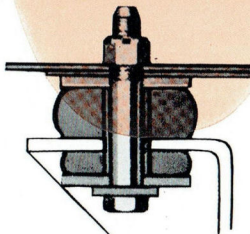

## 8. DEEP OFFSET HYPOID

**AXLE.** Deep offset Hypoid rear axle utilizes high-capacity differential gears and a straddle mounted pinion which maintains more accurate ring-gear tooth alignment. All gears are of alloy steel, heat treated for strength and durability.

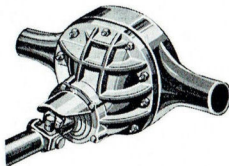

## 9. 4-SPEED TRANSMISSION

The 4-speed synchro-mission provides non-ability, more flexible cal operation than missions. Gears a to the mainshaft type synchronizers smooth, quiet gear with little driver ef

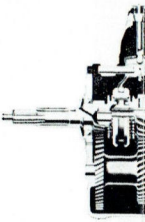

COUNT THE HOURS YOU'RE IN A CAB . . .  
 COUNT ON THE NEW FORD CABS FOR  
 DRIVERIZED COMFORT.

New Ford Driverized cabs offer the most in cab value—with even more comfort, safety and convenience—they're built stronger for longer life.

1. Wider, higher windscreen — with more square inches of safety-glass area—gives unobstructed vision forward, down and to the sides.
2. The new Ford F-250 cab is wider, lower and more comfortable—with plenty of head, leg and shoulder room for three large adults.
3. Doors open wide—and are held open by door checks—it's really easy to get in and out.
4. F-250's cab is heavily insulated for a quieter ride. Doors and wing vents are completely encircled by tight-fitting rubber seals.

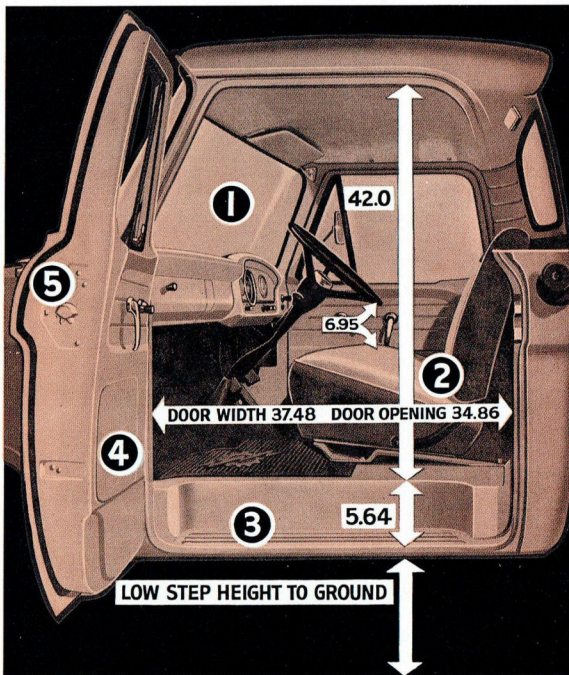

MISSION.  
 ore "pulling"  
 and economi-  
 3-speed trans-  
 connected  
 with blocker  
 to provide  
 engagement  
 fort.

**10. HEAVY-DUTY FRONT AXLE.**

F-250's bigger capacity front axle features heat-treated high carbon steel, rigid I-beam construction, with increased strength at stress points. Reverse Elliot steering knuckles, rugged steering arms and kingpins . . . and nylon kingpin bushings that cannot rust.

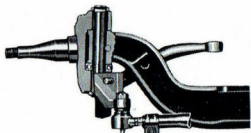

**11. NEW SHOCK ABSORBERS**

are of the direct double-acting type, providing a continuous damping effect on spring action both on compression and rebound. Rubber grommets at mounting points insulate against noise.

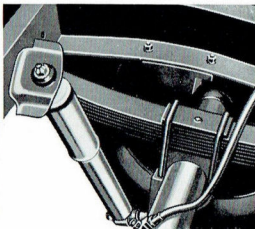

**12. NEW SAFETY FEATURES.**

Lifeguard steering wheel . . . positive tandem-action windscreen wipers . . . hooded fascia prevents distracting reflections when night driving . . . safety Double-Grip door latches . . . actuation for smooth, easy shifting, with less fatigue after a day's work.

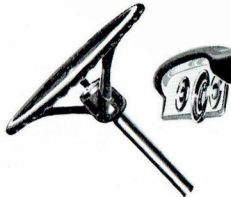

# FORD F250 TRUCKS

## ABRIDGED SPECIFICATIONS

**ENGINE:** V8 for high operating efficiency with push-rod-operated overhead valves operating in special chrome nickel alloy iron detachable cylinder heads. Short-stroke engine design. Bore 3.75. Stroke 3.30. Capacity 292 cubic ins. Compression ratio 8.0:1 R.A.C. and S.A.E. rating 45.00 H.P. Maximum B.H.P. Gross 172 @ 4,000 r.p.m. Net 146 @ 3,800 r.p.m. Maximum torque: Gross 270 lbs./ft. @ 2,000-2,600 r.p.m. Net 254 lbs./ft. @ 1,900-2,400 r.p.m. Engine mounted at 4 points with rubber-insulated bearings.

Cylinder block and crankcase cast in one piece, of high-grade chrome-nickel alloy iron. Crankcase extends 2 3/4" below centre of crankshaft for exceptional rigidity and better oil pan and crankcase sealing. 5 main-bearing precision-moulded alloy iron crankshaft. Each crankshaft is dynamically balanced to provide smooth engine performance and long engine life. Replaceable steel-backed copper lead main and big end bearings.

**PISTONS:** Tin-plated skirt aluminium alloy pistons of the autothermic design. Chrome-plated top piston ring, phosphate-coated lower compression ring and 3-piece oil control ring consisting of a serrated spring between two chrome-plated rails that exert "triple pressure" for excellent oil control.

**CYLINDER HEAD:** Special alloy iron cylinder heads have unusually uniform distribution of metal and water passages with improved circulation for efficient cooling and maximum stability. Made of the same high-grade material as the cylinder block, they have the same rate of expansion and contraction with temperature variations, thus providing freedom from distortion and leakage.

**ENGINE LUBRICATION:** High pressure from high-capacity rotor-type pump with pressure feed to all main and camshaft bearings via drilled passages in engine block and to all connecting rod bearings through drilled leads in crankshaft.

**OIL FILTRATION:** Full-flow oil filtration through a replaceable cartridge-type filter element. Filter assembly base mounted integral with cylinder block on lower left-hand side of engine completely eliminating external oil lines.

**CRANKCASE VENTILATION:** Direct flow crankcase ventilation removes corrosive vapours by continuous circulation of clean air through the engine. Due to the location of the outlet, the system effects a self-induced flow of air so that ventilation does not depend wholly upon blast from fan and is perfected to the extent that the air flow is divided, firstly to the upper part of the engine around the rocker mechanism, then down to the crankcase, secondly around the timing chain and then to the crankcase.

**OIL CAPACITY:** 8 pints plus 2 pints for filter absorption.

**FUEL:** Holley dual-down-draught low silhouette carburettor with externally adjusted fuel level setting. Acceleration pump, diaphragm operated and power valve vacuum operated for maximum power with fuel economy performance. Manually controlled choke with stroke and throttle controls inter-connected.

**FUEL SUPPLY:** By mechanical pump, driven from engine camshaft. Special filter element fitted in glass bowl protects fuel supply to engine and is readily removable for periodic service or maintenance.

**FUEL TANK CAPACITY:** 15 Imperial gallons.

**COOLING SYSTEM:** High-capacity series flow cooling system, resulting in direct water flow at high velocity from the front to rear of block on each bank, then through connecting passages in the cylinder heads over each combustion chamber and back to the outlet at the front for closer temperature control and eliminating hot spots, with the consequent reduction of tendency for engine to detonate. 4-bladed fan, diameter 18", with pressed steel cowling.

**COOLING SYSTEM CAPACITY:** 17.5 Imperial quarts.

**ELECTRICAL:** 12-volt electrical system. Coil and distributor with combined centrifugal and vacuum control for automatic advance and retard. Conical-tapered seat 18 mm. spark plugs. The conical-tapered plug seat eliminates the need for gaskets and once the plug is properly tightened, no torque loss is encountered, providing positive seating under high combustion pressures. Dual headlight system.

**BATTERY:** 12 volt 55 amp. per hr. capacity at 20 hr. rate. Negative terminal grounded.

**CLUTCH:** Single dry-disc type. Diameter 11". Spring-loaded centre for smooth drive. Frictional area 123.7 sq. ins.

**GEARBOX:** Cast iron casing. Four forward, one reverse speed standard equipment. Synchromesh on top, third and second. Constant mesh helical gears in top three speeds.

**GEAR BOX RATIOS:** 4 speed—First 6.40:1. Second 3.09:1. Third 1.69:1. Fourth 1:1. Reverse 7.82:1.

**POWER TAKE-OFF:** 6-bolt S.A.E. power take-off on right-hand side of transmission.

**GEARBOX CAPACITY:** 8 Imperial pints.

**DRIVE LINES:** Open propeller shaft provides smooth flow of power from the transmission to the rear axle. All units of the drive line are carefully designed and installed in the chassis with the proper inclination to produce straight line drive with minimum angularity between light and loaded positions.

**REAR AXLE:** Single-speed semi-floating axle. Axle shafts are chrome molybdenum steel forgings, heat-treated for toughness and high torsional strength. The rear axle utilises a hypoid-type drive gear and

pinion. Pinion gear is overhung to ensure accurate alignment under high torque loads. Axle ratio—4.88:1.

**FRONT AXLE:** Front axles feature high-strength, heat-treated forged alloy steel; axle centres of rigid I-beam type construction. Sections are increased at all high stress points. Reverse Elliot steering knuckles feature bolted-on stronger steering arms as well as stronger spindles.

**FRAME:** Deep channel section side members, parallel ladder-type frame construction. Cross members flanged "U" type with alligator jaw and channel sections. The parallel-type frame allows installation of both engine and steering gear mechanism within the protection of side rails.

**SPRINGS:** Semi-elliptic springs front and rear. Front springs are wide span with low deflection rate for desirable riding qualities and stability. The rear springs are long and wide for proper resilience and to carry the recommended load capacity under the most severe conditions. Dimensions—Front: 45" x 2". Rear: 52" x 2 1/4".

**STEERING BOX:** Recirculating ball steering gear design provides quick response to wheel, steady handling ease and rugged construction. Steering gear ratio 20:1.

**STEERING WHEEL:** Steel core with hard moulded rubber cover and grip. 17" diameter, centre horn button.

**STEERING BALL SOCKETS:** Tie-rod ends are spring-loaded, ball-socket type for automatic take-up of normal ball-socket wear.

**STEERING BOX CAPACITY:** .625 Imperial pints.

**TURNING CIRCLE DIAMETERS:** Right to left—41' 1". Left to right—41' 1". All measurements approximate—taken to centre line of outer wheel.

**BRAKES:** Full hydraulic system, operated by pedal acting on front and rear wheels. Total area drum lining, front and rear combined, 209.4 sq. ins.

**HAND BRAKES:** Equalised parking brake operates the rear wheel brakes mechanically by means of steel cables. An equaliser between the cables applies uniform pressure to each rear brake for straight-line emergency stops.

**FRONT BRAKES:** Single anchor duo-servo self-energising type.

Dimensions (drum diameter and lining width—thickness), 12 1/2" x 2" x 1/4".

**REAR BRAKES:** Single anchor duo-servo self-energising type.

Dimensions (drum diameter and lining width—thickness), 12 1/2" x 2" x 1/4".

**WHEELS AND TYRES:** Wheels are of the drop centre type. Rim sizes—17 x 5.50—5 wheels. Standard tyre equipment—front, rear and spare (all tube and tyre combination).

Tyre sizes—7.50 x 17—8 ply.

# FORD F250 TRUCKS

## ABRIDGED SPECIFICATIONS

**CAB:** All-steel welded structure of 3-man design. Boxed section construction in windshield header and filler posts for maximum safety and durability.

**CAB MOUNTING:** The heavy truck 3-point cab-mount system has a far-reaching effect toward virtually eliminating vibration, noise and torsional twist between cab and frame for greater driver comfort and extended sheet metal life.

**INSTRUMENT PANEL:** Curved panel with easy-to-read full vision instrument cluster containing fuel gauge, oil pressure and charge indicator lights, speedometer and temperature gauge.

**DOORS:** All steel construction mounted on concealed goose-necked hinges. Door checks built into hinges hold doors in open position. Push button handles with rugged rotor-type safety latches. Continuous weather stripping around doors with weather sealed Air Wing Vents.

**WINDOWS:** Full-width windshield, with rear window over 4' wide, large door windows, giving total glass area of 2,643.74 sq. ins. for all-round visibility.

**SEATING:** Full-width seat with formed wire springs. Improved basic construction gives added support for back and knees. 4½" fingertip seat adjustment. Cushion and back-rest covered in durable Vinyl.

**VENTILATION:** Hi-dri all-weather ventilation, round grille-type defroster vents that direct air to eye level on windshield for quick, safe visibility.

**CHASSIS EQUIPMENT:** Included as standard in addition to items mentioned above: Hood, cowl and dash assembly; front and rear fenders; Hi-dri cowl ventilators; steel speed board; instrument panel; speedometer; water temperature gauge; oil pressure warning light; fuel gauge; ash receptacle; glove box; horn; electric windshield wipers; treadle-type accelerator pedal; long arm outside rear view mirror on chassis cab; internal sunvisor; standard tools in bag, spare wheel, tyre and tube.

Ford Motor Company of Australia Pty. Ltd., whose policy is one of continuous improvement, reserves the right, subject to such regulations as may from time to time apply, to change specifications and prices at any time without notice or incurring liability to purchasers.

### GENERAL DIMENSIONS F250

Wheelbase .....	122"
Track, Front .....	60.8"
Track, Rear .....	62"
Max. Overall Length (to end of frame) .....	202.1"
Max. Width of Vehicle (bumpers) .....	79.8"
Width across Front Seat .....	56.7"
Back of Cab to End of Frame .....	94.6"

### CHASSIS DIMENSIONS

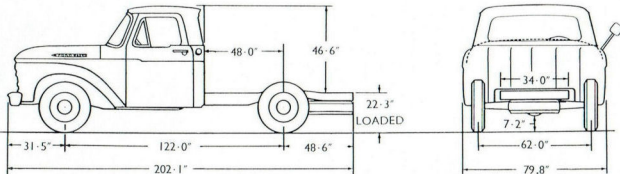

DM 11 12/61

**FORD MOTOR COMPANY OF AUSTRALIA PTY. LTD.**

(Incorporated in Victoria) Reg. Office: Geelong, Victoria

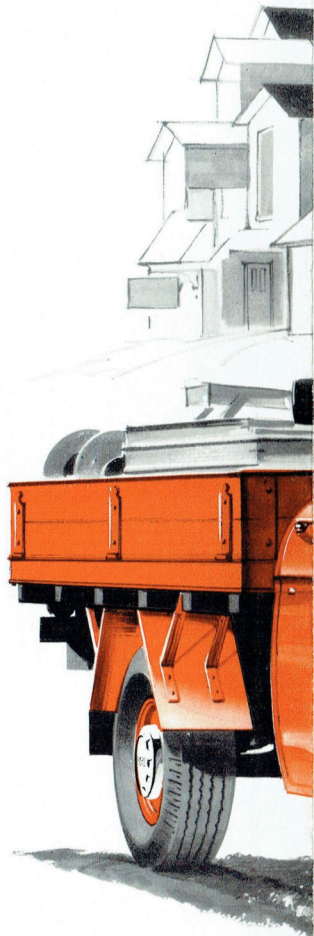

# FORD F250 TRUCKS

## ABRIDGED SPECIFICATIONS

**ENGINE:** V8 for high operating efficiency with push-rod-operated overhead valves operating in special chrome nickel alloy iron detachable cylinder heads. Short-stroke engine design. Bore 3.75. Stroke 3.30. Capacity 292 cubic ins. Compression ratio 8.0:1 R.A.C. and S.A.E. rating 45,000 H.P. Maximum B.H.P. Gross 172 @ 4,000 r.p.m. Net 146 @ 3,800 r.p.m. Maximum torque, Gross 270 lbs./ft. @ 2,000-2,600 r.p.m. Net 254 lbs./ft. @ 1,900-2,400 r.p.m. Engine mounted at 4 points with rubber-insulated bearers.

Cylinder block and crankcase cast in one piece, of high-grade chrome-nickel alloy iron. Crankcase extends 2 3/4" below centre of crankshaft for exceptional rigidity and better oil pan and crankcase sealing. 5 main-bearing precision-moulded alloy iron crankshaft. Each crankshaft is dynamically balanced to provide smooth engine performance and long engine life. Replaceable steel-backed copper lead main and big end bearings.

**PISTONS:** Tin-plated skirt aluminium alloy pistons of the autothermic design. Chrome-plated top piston ring, phosphate-coated lower compression ring and 3-piece oil control ring consisting of a serrated spring between two chrome-plated rails that exert "triple pressure" for excellent oil control.

**CYLINDER HEAD:** Special alloy iron cylinder heads have unusually uniform distribution of metal and water passages with improved circulation for efficient cooling and maximum stability. Made of the same high-grade material as the cylinder block, they have the same rate of expansion and contraction with temperature variations, thus providing freedom from distortion and leakage.

**ENGINE LUBRICATION:** High pressure from high-capacity rotor-type pump with pressure feed to all main and camshaft bearings via drilled passages in engine block and to all connecting rod bearings through drilled leads in crankshaft.

**OIL FILTRATION:** Full-flow oil filtration through a replaceable cartridge-type filter element. Filter assembly base mounted integral with cylinder block on lower left-hand side of engine completely eliminating external oil lines.

**CRANKCASE VENTILATION:** Direct flow crankcase ventilation removes corrosive vapours by continuous circulation of clean air through the engine. Due to the location of the outlet, the system effects a self-induced flow of air so that ventilation does not depend wholly upon blast from fan and is perfected to the extent that the air flow is divided, firstly to the upper part of the engine around the rocker mechanism, then down to the crankcase, secondly around the timing chain and then to the crankcase.

**OIL CAPACITY:** 8 pints plus 2 pints for filter absorption.

**FUEL:** Holley dual-down draught low silhouette carburettor with externally adjusted fuel level setting. Acceleration pump, diaphragm operated and power valve vacuum operated for maximum power with fuel economy performance. Manually controlled choke with stroke and throttle controls inter-connected.

**FUEL SUPPLY:** By mechanical pump, driven from engine camshaft. Special filter element fitted in glass bowl protects fuel supply to engine and is readily removable for periodic service or maintenance.

**FUEL TANK CAPACITY:** 15 Imperial gallons.

**COOLING SYSTEM:** High-capacity series flow cooling system, resulting in direct water flow at high velocity from the front to rear of block on each bank, then through connecting passages in the cylinder heads over each combustion chamber and back to the outlet at the front for closer temperature control and eliminating hot spots, with the consequent reduction of tendency for engine to detonate. 4-bladed fan, diameter 18", with pressed steel cowl.

**COOLING SYSTEM CAPACITY:** 17.5 Imperial pints.

**ELECTRICAL:** 12-volt electrical system. Coil and distributor with combined centrifugal and vacuum control for automatic advance and retard. Conical-tapered seat 18 mm. spark plugs. The conical-tapered plug seat eliminates the need for gaskets and once the plug is properly tightened, no torque loss is encountered, providing positive seating under high combustion pressures. Dual headlight system.

**BATTERY:** 12 volt 55 amp. per hr. capacity at 20 hr. rate. Negative terminal grounded.

**CLUTCH:** Single dry-disc type. Diameter 11". Spring-loaded centre for smooth drive. Frictional area 123.7 sq. ins.

**GEARBOX:** Cast iron casing. Four forward, one reverse speed standard equipment. Synchronesh on top, third and second. Constant mesh helical gears in top three speeds.

**GEAR BOX RATIOS:** 4 speed—First 6.40:1. Second 3.09:1. Third 1.69:1. Fourth 1:1. Reverse 7.82:1.

**POWER TAKE-OFF:** 6-bolt S.A.E. power take-off on right-hand side of transmission.

**GEARBOX CAPACITY:** 8 Imperial pints.

**DRIVE LINES:** Open propeller shaft provides smooth flow of power from the transmission to the rear axle. All units of the drive line are carefully designed and installed in the chassis with the proper inclination to produce straight line drive with minimum angularity between light and loaded positions.

**REAR AXLE:** Single-speed semi-floating axle. Axle shafts are chrome molybdenum steel forgings, heat-treated for toughness and high torsional strength. The rear axle utilises a hypoid-type drive gear and

pinion. Pinion gear is overhung to ensure accurate alignment under high torque loads. Axle ratio—4.88:1.

**FRONT AXLE:** Front axles feature high-strength, heat-treated forged alloy steel; axle centres of rigid I-beam type construction. Sections are increased at all high stress points. Reverse Elliot steering knuckles feature bolted-on stronger steering arms as well as stronger spindles.

**FRAME:** Deep channel section side members, parallel ladder-type frame construction. Cross members flanged "U" type with alligator jaw and channel sections. The parallel-type frame allows installation of both engine and steering gear mechanism within the protection of side rails.

**SPRINGS:** Semi-elliptic springs front and rear. Front springs are wide span with low deflection rate for desirable riding qualities and stability. The rear springs are long and wide for proper resilience and to carry the recommended load capacity under the most severe conditions. Dimensions—Front: 45" x 2". Rear: 52" x 2 1/4".

**STEERING BOX:** Recirculating ball steering gear design provides quick response to wheel, steady handling ease and rugged construction. Steering gear ratio 20:1.

**STEERING WHEEL:** Steel core with hard moulded rubber cover and grip. 17" diameter, centre horn button.

**STEERING BALL SOCKETS:** Tie-rod ends are spring-loaded, ball-socket type for automatic take-up of normal ball-socket wear.

**STEERING BOX CAPACITY:** 625 Imperial pints.

**TURNING CIRCLE DIAMETERS:** Right to left—41' 1". Left to right—41' 1". All measurements approximate—taken to centre line of outer wheel.

**BRAKES:** Full hydraulic system, operated by pedal acting on front and rear wheels. Total area drum lining, front and rear combined, 209.4 sq. ins.

**HAND BRAKES:** Equalised parking brake operates the rear wheel brakes mechanically by means of steel cables. An equaliser between the cables applies uniform pressure to each rear brake for straight-line emergency stops.

**FRONT BRAKES:** Single anchor duo-servo self-energising type. Dimensions (drum diameter and lining width—thickness), 12 1/2" x 2" x 1/4".

**REAR BRAKES:** Single anchor duo-servo self-energising type. Dimensions (drum diameter and lining width—thickness), 12 1/2" x 2" x 1/4".

**WHEELS AND TYRES:** Wheels are of the drop centre type. Rim sizes—17 x 5.50—5 wheels. Standard tyre equipment—front, rear and spare (all tube and tyre combination). Tyre sizes—7.50 x 17—8 ply.

# FORD F250 TRUCKS

## ABRIDGED SPECIFICATIONS

**CAB:** All-steel welded structure of 3-man design. Boxed section construction in windshield header and filler posts for maximum safety and durability.

**CAB MOUNTING:** The heavy truck 3-point cab-mount system has a far-reaching effect toward virtually eliminating vibration, noise and torsional twist between cab and frame for greater driver comfort and extended sheet metal life.

**INSTRUMENT PANEL:** Curved panel with easy-to-read full vision instrument cluster containing fuel gauge, oil pressure and charge indicator lights, speedometer and temperature gauge.

**DOORS:** All steel construction mounted on concealed goose-necked hinges. Door checks built into hinges hold doors in open position. Push button handles with rugged rotor-type safety latches. Continuous weather stripping around doors with weather sealed Air Vents.

**WINDOWS:** Full-width windshield, with rear window over 4' wide, large door windows, giving total glass area of 2,643.74 sq. ins. for all-round visibility.

**SEATING:** Full-width seat with formed wire springs. Improved basic construction gives added support for back and knees. 4 1/2" fingertip seat adjustment. Cushion and back-rest covered in durable Vinyl.

**VENTILATION:** Hi-dri all-weather ventilation, round grille-type defroster vents that direct air to eye level on windshield for quick, safe visibility.

**CHASSIS EQUIPMENT:** Included as standard in addition to items mentioned above: Hood, cowl and dash assembly; front and rear fenders; Hi-dri cowl ventilators; steel toe board; instrument panel; speedometer; water temperature gauge; oil pressure warning light; fuel gauge; ash receptacle; glove box; horn; electric windshield wipers; treadle-type accelerator pedal; long arm outside rear view mirror on chassis cab; internal sun visor; standard tools in bag, spare wheel, tyre and tube.

Ford Motor Company of Australia Pty. Ltd., whose policy is one of continuous improvement, reserves the right, subject to such regulations as may from time to time apply, to change specifications and prices at any time without notice or incurring liability to purchasers.

### GENERAL DIMENSIONS F250

Wheelbase	122"
Track, Front	60.8"
Track, Rear	62"
Max. Overall Length (to end of frame)	202.1"
Max. Width of Vehicle (bumpers)	79.8"
Width across Front Seat	56.7"
Back of Cab to End of Frame	94.6"

### CHASSIS DIMENSIONS

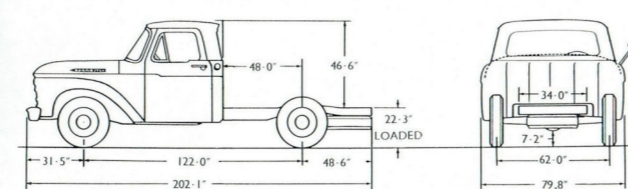

DM 11 12/61

**FORD MOTOR COMPANY OF AUSTRALIA PTY. LTD.**

(Incorporated in Victoria) Reg. Office: Geelong, Victoria

# NEW FORD V8 F250 TRUCKS

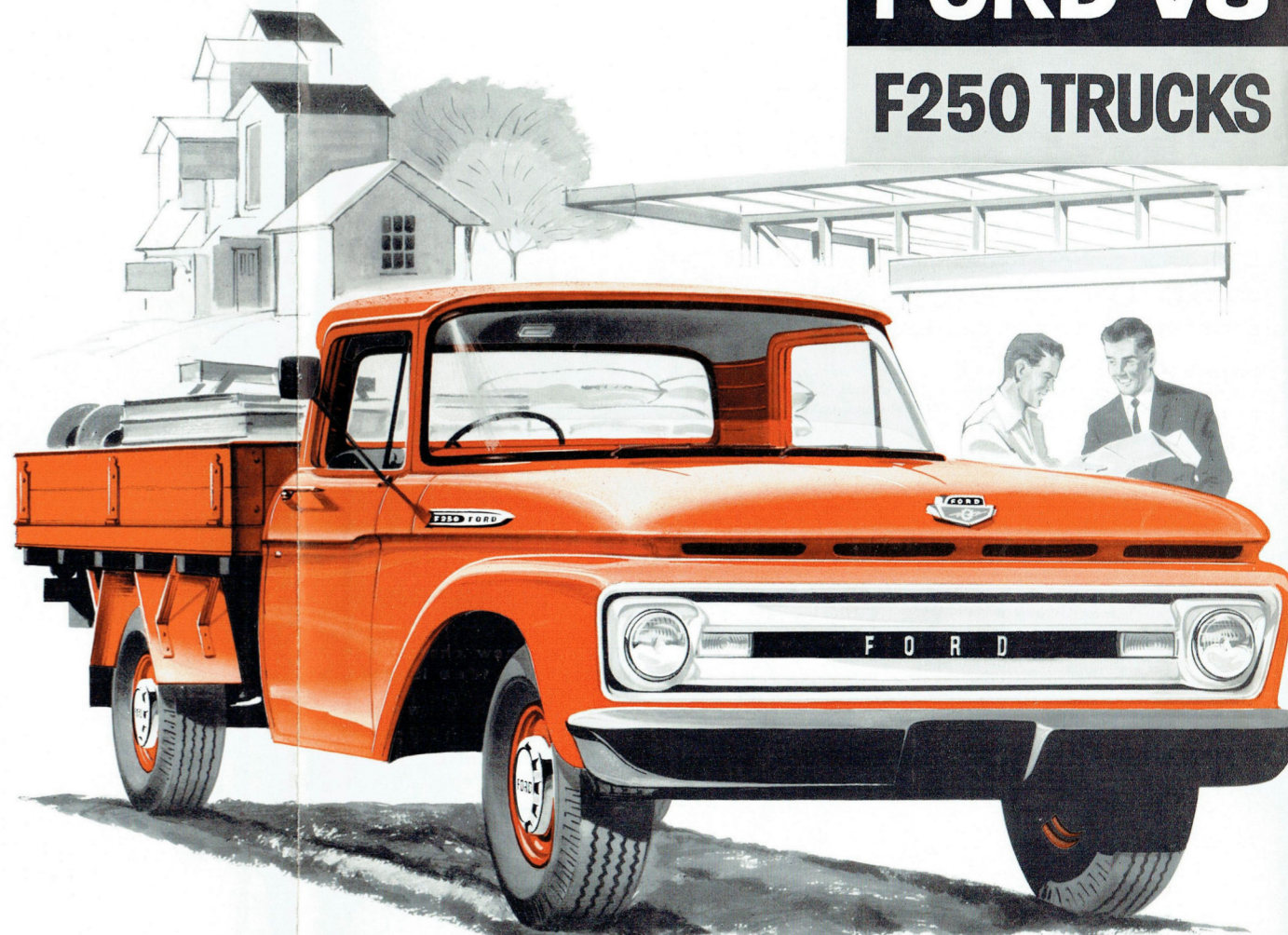

Toughest line of Ford trucks yet

**FORD**  
**F250**  
TRUCKS

VERSATILE, EASY TO HANDLE, WITH  
PROVEN V8 MONEY-MAKING POWER



Big power and big torque in this well-proven 292 series Ford V8 engine — plus all of Ford's famous short-stroke economy and long life!

The proven big-muscled work capacity of this short-stroke V8, combined with big power and thrift, make it the most efficient unit in the field. You get fullest benefit of modern short-stroke design. Shorter piston travel, slower piston speeds, and higher compression ratio, develops high horsepower and torque with less engine effort and wear. There's more usable power for every gallon of fuel and longer engine life. Net maximum B.H.P. is 146 at 3,800 r.p.m., and the high net torque of 254 lbs./ft. is obtained at the low revolutionary rate from 1,900-2,400 r.p.m. This 292 cubic inch V8 engine has a high

8.0:1 compression ratio built to keep "new engine" efficiency at its peak. By combining short-stroke design with large cylinder bores, internal friction and heat losses are reduced, usable power and economy are increased. The result? Greater operating efficiency. Large diameter cylinder bores also permit greater diameter valves and therefore excellent breathing characteristics. The 5-bearing crankshaft material provides great rigidity and stability to withstand the toughest truck operations. Valve guides are integrally cast as part of the cylinder heads. They are superior to the usual inserts, with better heat transfer and large valve life.

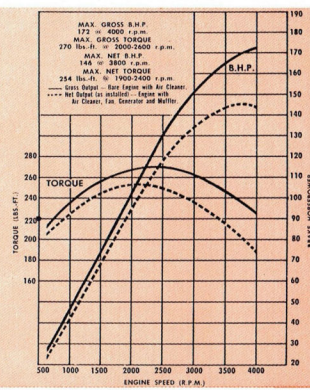
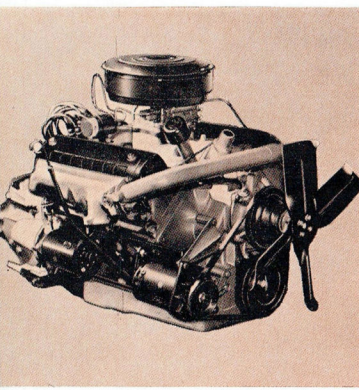

12,000-MILE, 12-MONTH  
(whichever comes first)  
**WARRANTY**  
ON ALL FORD TRUCKS  
(excepting normal maintenance parts and service)

Tough, all-new chassis has extra strength where it counts.

Ford V8 F-250's sturdy new chassis provides extra strength and payload capacity where it counts; to get more work done with less expense. Durable brakes, springs, frame and axles all have the reserve capacity to stand up in hard service. Ford have been builders of tough, hardworking trucks for many years — and this is the toughest line of Ford trucks yet!

ABRIDGED SPECIFICATIONS

Wheelbase	Max. Side Rail Section	Section Modulus
122"	6.0" x 2.25" x 0.19"	3.34

**1. RADIATOR** has soldered lock-seam joint construction and thicker tank and header walls for strength and durability. Independent mounting system prevents transfer of road shocks through sheet metal and greatly extends radiator life.

**2. SERVICE BRAKES** have the capacity and lining area to control F-250's rated load. They are of heavy-duty construction to withstand hard, constant use with maximum efficiency.

**3. FRONT SPRINGS** give a much smoother ride empty or loaded. At the front end, a full loop of the main leaf and half wrap of the second leaf increases spring reliability and provides added safety.

**4. DROP FRAME** in cab mounting area allows 1½ inches less step height for easier entry into cab, and provides a lower cab silhouette.

**5. REAR SPRINGS** are a full 4 inches longer and ½ inch wider for improved riding characteristics. They are sturdier, and of heavier rated capacity.

Another 'First' from Ford to put you first: "12/12 Warranty" gives a big new owner-benefit to all F-250 users.

Ford V8 Trucks give you broader warranty — extended to 12,000 miles or 12 months, whichever comes first. Every Ford V8 Truck is warranted against defects in materials and workmanship for this new extended period. Owners are responsible only for normal maintenance and routine replacement of maintenance items. This big extra owner-benefit is provided without any increase in the low prices of Ford V8 Trucks.

**6. BIGGER, STRONGER FRAME** with bigger side rails on 122 inch wheelbase models to give more frame rigidity for longer frame, cab and body durability. Stronger parallel ladder-type frame construction features heavy gauge channel side members and flanged "U"-type crossmembers. Frames are of S.A.E. standard "X" to facilitate mounting of standard or custombuilt bodies.

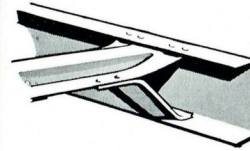

**7. NEW CAB MOUNTINGS.** F-250's new system of rubber-cushioned 3-point cab-mounting provides a better ride, insulates the cab against frame stresses and vibration, reducing sheet metal strains. The system accordingly increases cab-life and improves the operator's comfort.

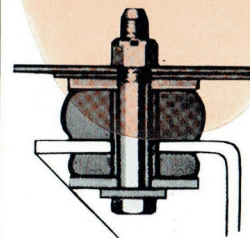

**8. DEEP OFFSET HYPOID AXLE.** Deep offset Hypoid rear axle utilizes high-capacity differential gears and a straddle mounted pinion which maintains more accurate ring-gear tooth alignment. All gears are of alloy steel, heat treated for strength and durability.

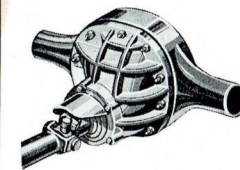

**9. 4-SPEED TRANSMISSION.** The 4-speed synchro-silent transmission provides more "pulling" ability, more flexible and economical operation than 3-speed transmissions. Gears are connected to the mainshaft with blocker type synchronizers to provide smooth, quiet gear engagement with little driver effort.

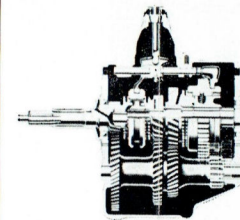

**10. HEAVY-DUTY FRONT AXLE.** F-250's bigger capacity front axle features heat-treated high carbon steel, rigid I-beam construction, with increased strength at stress points. Reverse Elliot steering knuckles, rugged steering arms and kingpins . . . and nylon kingpin bushings that cannot rust.

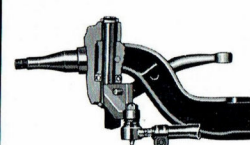

**11. NEW SHOCK ABSORBERS** are of the direct double-acting type, providing a continuous damping effect on spring action both on compression and rebound. Rubber grommets at mounting points insulate against noise.

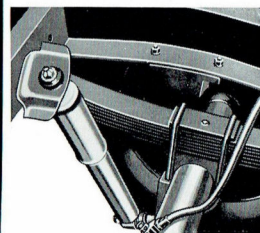

**12. NEW SAFETY FEATURES.** Lifeguard steering wheel . . . positive tandem-action windshield wipers . . . hooded fascia prevents distracting reflections when night driving . . . safety Double-Grip door latches . . . actuation for smooth, easy shifting, with less fatigue after a day's work.

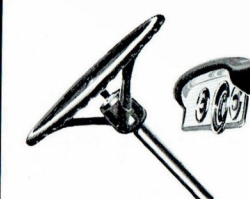

COUNT THE HOURS YOU'RE IN A CAB . . . COUNT ON THE NEW FORD CABS FOR DRIVERIZED COMFORT.

New Ford Driverized cabs offer the most in cab value — with even more comfort, safety and convenience — they're built stronger for longer life.

1. Wider, higher windscreen — with more square inches of safety-glass area — gives unobstructed vision forward, down and to the sides.

2. The new Ford F-250 cab is wider, lower and more comfortable — with plenty of head, leg and shoulder room for three large adults.

3. Doors open wide — and are held open by door checks — it's really easy to get in and out.

4. F-250's cab is heavily insulated for a quieter ride. Doors and wing vents are completely encircled by tight-fitting rubber seals.

