

CHEVROLET SILVERADO

2022 CHASSIS CAB



4500 HD | 5500 HD | 6500 HD





We're the foundation of any business.



STRENGTH ON DISPLAY.

Getting the job done takes power, strength and dependability. That's why Silverado Chassis Cab is built with loads of all three. The Duramax® 6.6L Turbo-Diesel V8 engine has been optimized to deliver brute strength and legendary reliability that lives up to the Duramax name. Putting power to the ground is a variety of Allison® Transmission and axle ratio options suited to the needs of your business, each featuring durability you can depend on. You built your business to be a powerhouse. We built a truck you can count on to make it happen.

Shown throughout with equipment from independent suppliers, which is not covered by the GM New Vehicle Limited Warranty. GM is not responsible for the safety or quality of independent supplier alterations.

 DURAMAX®
6.6L V8
Turbo-Diesel Engine

 **350 HP**
@ 2700 RPM

 **700 LB.-FT.**
Torque @ 1600 RPM

 ALLISON®
6-SPEED
Automatic Transmission



 **DURAMAX**

DOWNTIME ISN'T PART OF OUR DESIGN.

Keeping your trucks on the road is a crucial part of keeping your business on the road. The Silverado Chassis Cabs are built with that in mind. From the design of the hood to the placement of vital components, everything is designed to help make maintenance as quick and painless as possible.



TILT FORWARD ENGINE COVER

Lightweight fiberglass tilt engine cover with integrated hand grips for easy access and a built-in lock to keep it securely open.



CONVENIENT DEF TANK

With the DEF tank located low, outside of the hood and away from the fuel tank, drivers can fill it easily and avoid confusion.



BATTERY BOX

Easy-to-reach battery box with available auxiliary jump-start stud located right below the driver side of the cab.

WHEEL CUT 50°

Up to 50 degrees of wheel cut allows for easy access to the engine bay and can save time on maintenance.

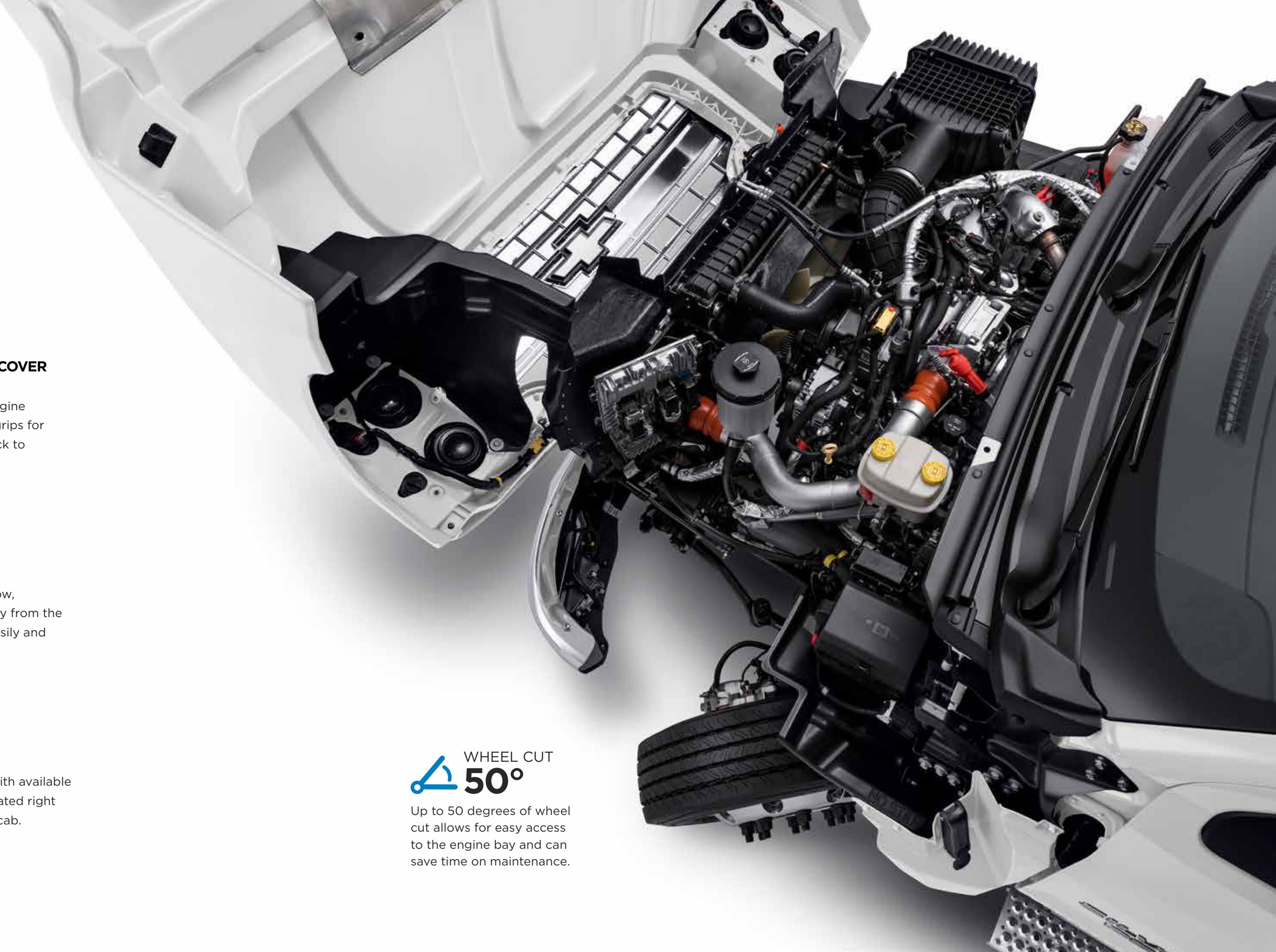

CONNECTIVITY THAT WORKS AS HARD AS YOU DO.

Help keep your fleet connected and on top of their tasks thanks to the advanced connectivity and mobile office features available in the Silverado Chassis Cab that can help your drivers stay focused on the road ahead. With built-in telematics features integrated into the vehicle, your fleet can be equipped with the brains to match its brawn.



AVAILABLE 8" DIAGONAL TOUCH-SCREEN

Without handling their phones, drivers can access calls, alerts and notifications on the available Chevrolet Infotainment System¹ with 8-inch diagonal color touch-screen.

AVAILABLE Apple CarPlay^{®2} & Android Auto^{™3}

Seamless smartphone integration puts contacts, maps, messages and more at your drivers' fingertips with available Apple CarPlay and Android Auto compatibility.

AVAILABLE WIRELESS CHARGING⁴

Drivers and crew can use and charge a single device without cords cluttering the cab anytime the vehicle is running, thanks to available wireless charging.



AUXILIARY SWITCHES

Get up to 13 factory-installed switches to run auxiliary equipment. The seven switches shown, including exhaust brake, are standard. You can also add an optional headliner switchbank for six additional open switches.

AVAILABLE 110-VOLT OUTLET

Keep devices, tools and batteries fully charged with the available 110-volt outlet.

 AVAILABLE HANDS-FREE
BLUETOOTH^{®5}
Hands-free calling and communication

 AVAILABLE Wi-Fi[®]
HOTSPOT⁶
Wi-Fi Hotspot connects up to seven devices to help boost your fleet's productivity

 REAR VISION
CAMERA⁷
Helps drivers navigate in Reverse
Shipped loose for upfitter installation.



ONSTAR BUSINESS SOLUTIONS

Assist drivers during a crisis⁸ deliver turn-by-turn⁹ directions and work with local law enforcement to help recover lost or stolen vehicles with the safety and security of OnStar embedded hardware.¹⁰

ONSTAR VEHICLE INSIGHTS[™]

OnStar Vehicle Insights¹¹ lets you easily monitor your fleet's vital statistics such as speed, location and vehicle performance in real time. It's the convenient and affordable way to get the most out of your fleet vehicles.

¹Functionality varies by model. Full functionality requires compatible Bluetooth and smartphone. Some devices require USB connectivity. ²Vehicle user interface is a product of Apple[®] and its terms and privacy statements apply. Requires compatible iPhone[®] and data plan rates apply. Apple CarPlay, Siri, iPhone and Apple Music are trademarks of Apple, Inc., registered in the U.S. and other countries. ³To use Android Auto on your car display, you'll need an Android phone running Android 6.0 or higher, an active data plan, and the Android Auto app. You can check which smartphones are compatible at g.co/androidauto/requirements. Google, Android, and Android Auto are trademarks of Google LLC. ⁴The system wirelessly charges one compatible mobile device. Some phones have built-in wireless charging technology and others require a special adaptor/back cover. To check for phone or other device compatibility, see my.chevrolet.com/learn or consult your carrier.

⁵Go to my.chevrolet.com/learnAbout/bluetooth to find out which phones are compatible with the vehicle. ⁶Service varies with conditions and location. Requires active services and paid data plan offered by AT&T. See onstar.com for details and limitations. ⁷Safety or driver assistance features are no substitute for the driver's responsibility to operate the vehicle in a safe manner. The driver should remain attentive to traffic, surroundings and road conditions at all times. Visibility, weather and road conditions may affect feature performance. Read the vehicle Owner's Manual for more important feature limitations and information. ⁸OnStar plan, working electrical system, cell reception and GPS signal required. OnStar links to emergency services. See onstar.com for details and limitations. ⁹OnStar plan, working electrical system, cell reception and GPS signal required. OnStar links to emergency services. See onstar.com for details and limitations. ¹⁰OnStar plan, working electrical system, cell reception and GPS signal required. OnStar links to emergency services. Stolen Vehicle Assistance requires armed GM factory-installed theft-deterrent system, contact method on file and enrollment to receive alerts. Additional messaging and data rates may apply. Services are intended to assist with vehicle recovery and do not prevent theft or protect against damage or loss. See onstar.com for details and limitations. ¹¹Terms apply. Available on select properly equipped 2015 model year and newer GM vehicles (excludes Volt, Low Cab Forward trucks and GM vehicles built without OnStar hardware, which includes but is not limited to select base Chevrolet and GMC trucks). Requires an active connected vehicle services plan. Fees, services and availability subject to change without notice. Applicable taxes not included. Does not include emergency or security services. Diagnostics capabilities vary by vehicle model. Not all issues will deliver alerts. See onstarvehicleinsights.com for details and limitations.

ALL COMFORT. EVERY RIDE.

It takes more than just powerful performance to get the job done, so the Silverado Chassis Cab interior is focused on helping to make drivers and crew confident and comfortable on the job. Available in either Regular Cab or Crew Cab with features such as easy-to-reach knobs, buttons and interfaces, inlaid doors, available Remote Start¹ and an available center console featuring four USB² ports, a 110-volt outlet and integrated file storage, Silverado Chassis Cab blends comfort with capability.



CROWD CONTROL

When the job calls for a bigger crew, Silverado Chassis Cab can move up to six people with its customizable interior featuring high-wear cloth seats and an available 10-way power driver seat.

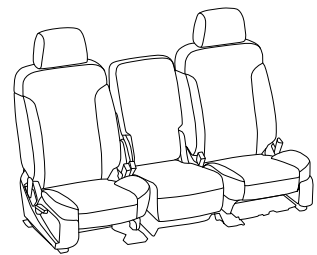

40/20/40 BENCH SEAT

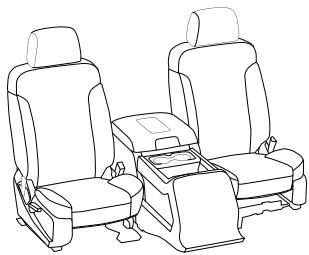

BUCKET SEATS

¹Requires subscription to Remote Access Plan or Unlimited Access Plan. Services are subject to user terms and limitations and vary by vehicle model. Unlock feature requires automatic locks. Remote Start requires GM factory-installed and enabled remote start system. Visit onstar.com for more details. ²Not compatible with all devices.

STANDARD 6 AIRBAGS¹

Silverado Chassis Cab features frontal, seat-mounted side-impact and head-curtain airbags

SAFETY IS JOB NO. 1

Silverado Chassis Cab offers single-stage frontal airbags and seat-mounted side-impact airbags for both driver and front outboard passenger, as well as head-curtain airbags for outboard seating positions in both Regular and Crew Cab configurations. Plus, StabiliTrak[®] Electronic Stability Control System is standard.

¹Always use seat belts and child restraints. Children are safer when properly secured in a rear seat in the appropriate child restraint. See the vehicle Owner's Manual for more information.

AVAILABLE LOCKING REAR DIFFERENTIAL

Available locking rear differential helps provide stability when vehicle is parked and aerial device is in use.



MANEUVER WITH CONTROL

A wheel cut of up to 50 degrees, available locking rear differential and an optional front stabilizer bar give Silverado Chassis Cab handling and traction that match its extraordinary strength.

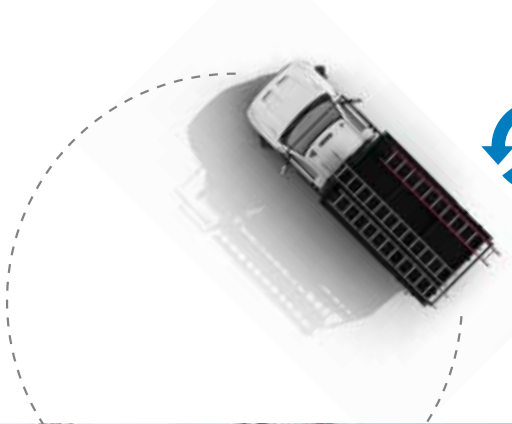

TURNING DIAMETER
41.2 FT.* Curb to Curb

*2022 Chevrolet Silverado Medium-Duty Regular Cab 2WD with 141-inch wheelbase.



COMMAND ANY WORKSITE.

Silverado Chassis Cab is built to deliver productivity for your business, and it’s also built with your drivers in mind. An impressive turning radius combined with driver-focused design features means drivers can easily maneuver Silverado Chassis Cab’s enormous muscle.

A. EXTERIOR MIRRORS

Silverado Chassis Cab offers exterior mirrors that are extendable with available power adjustment, heat and integrated turn signals.

B. ASSIST STEPS

The standard black steel or available aluminum assist steps allow drivers and workers to easily access the cab and provide a rough, ventilated surface to scrape off mud, snow and ice from their footwear.

C. HOOD DESIGN

The downward sloping design of the hood gives drivers better forward visibility to help with views of the road and the job site.



8
CAB-TO-AXLE
Options

10
WHEELBASE
Options

5
AXLE-TO-END-OF-FRAME
Options

START WITH A SOLID FOUNDATION.

Silverado Chassis Cab is designed for medium-duty use with a solid straight-frame design and a clean top-of-rail that simplifies the upfit¹ process. It also provides a variety of wheelbase, axle and cab-to-axle options as well as up to 13 auxiliary switches and available rear work light provisions to create the right vehicle for your work environment.



ADDED DURABILITY

Huck[®] bolt fasteners provide structural durability, while a specialized frame assembly and paint process help offer an extra level of protection from corrosion.

FLEXIBLE

A variety of exhaust routing options and through-the-frame fuel fill, as well as multiple fuel tank configurations, accommodate the needs of a wide array of upfits.

CLEAN TOP OF FRAME

Single-piece frame rails with no welds or brackets and a clean top-of-rail allow for optimized upfit integration.

 MAX GVWR²
23,500 LBS.

¹Equipment from independent suppliers is not covered by the GM New Vehicle Limited Warranty. GM is not responsible for the safety or quality of independent supplier alterations. ²Gross Vehicle Weight Rating (GVWR). When properly equipped; includes weight of vehicle, passengers, cargo and equipment.



AVAILABLE FACTORY-INSTALLED **REAR AIR SUSPENSION**

With air compressor accessory drive.
Available with heated air dryer.



ONE SMOOTH RIDE.

For vehicles that require a more compliant ride, an available factory-installed rear air suspension creates a smoother ride for drivers, crew and cargo while also giving Silverado Chassis Cab the ability to adjust rear load height for easy loading and unloading.



AVAILABLE EMERGENCY SERVICE PACKAGE

Emergency Service Package includes dual alternators,
backup alarm and end of cab wiring provisions.

VERSATILE PLATFORM

The solid, straight-frame design with a variety of wheelbase and axle-to-end-of-frame options enables Silverado Chassis Cab to accommodate upfits¹ up to 24' in length, making it ideal for rollback upfits.

¹Equipment from independent suppliers is not covered by the GM New Vehicle Limited Warranty. GM is not responsible for the safety or quality of independent supplier alterations.



**AVAILABLE
SNOW PLOW PREP PACKAGE**

Snow Plow Prep Package with auxiliary harness for headlamps and turn signals, factory-installed mounting locations built into the frame, 220-amp alternator, and provision for cab roof-mounted lamp/beacon.

BUILT FOR THE JOB.

From dump trucks to rollbacks and snow plows to ambulance bodies, Silverado Chassis Cab is the ideal platform for whatever your fleet is counting on to finish the job.



ROLLBACK



BUCKET



DUMP BODY



STAKE BODY



SERVICE BODY



AMBULANCE



CONTRACTOR BODY

OVERACHIEVES IN THE EXTREMES.

Validated in extreme heat and bitter cold, Silverado Chassis Cab can be configured for use in the harshest environments. The available Power Take-Off gives your fleet the capability to power auxiliary equipment, and the standard trailer brake controller and standard 4-channel ABS brake system help drivers maintain control while towing heavy cargo. When just getting to the job site is part of the challenge, features such as StabiliTrak®, 4-wheel drive, transfer case skid plate, limited-slip differential, locking rear axle or recovery hooks¹ can help your crews tackle the elements.



KUV



BOX



PLOW & SPREADER

¹To avoid the risk of injury, never use Recovery hooks to tow a vehicle. For more information, see the Recovery hooks section of your vehicle Owner's Manual.



**DEPENDABILITY
RUNS IN THE FAMILY**

SELECT FEATURES

INTERIOR	WT	LT	EXTERIOR	WT	LT	MECHANICAL	WT	LT
Air Conditioning, Single Zone	S	S	Black Front Bumper	S	S	Duramax® 6.6L Turbo-Diesel V8 Engine	S	S
Airbags¹	S	S	Chrome Front Bumper	A	A	Allison® Transmission	S	S
Auxiliary Switch Bank	S	S	Gray Front Bumper	A	A	150-Amp Alternator	S	S
Auxiliary Headliner Switchbank	A	A	Black Door Handles	S	S	220-Amp Alternator	A	A
Audio System with 4.2" Color Display	S	N/A	Chrome Door Handles	A	A	Dual Alternators, 150-Amp and 220-Amp	A	A
Audio System with 7" Diagonal Color Display	A	N/A	Fog Lamps	A	A	Batteries, Heavy-Duty Dual 1100 CCA	S	S
Audio System with 8" Diagonal Color Display	N/A	S	Black Grille	S	S	Heavy-Duty Hydraulic Brakes	S	S
Seat Belts, Orange Front	A	A	Chrome Grille	A	A	Rear-Mounted 40-Gallon Fuel Tank	S	S
Seat Belts, Red Front	A	A	Grille Guard Screen (Stone Protection)	A	A	Front-Mounted 25-Gallon Fuel Tank	A	A
USB Port²	S	S	Grille Guard Screen (Insect Protection)	S	S	Dual Front and Rear Fuel Tanks, 65-Gallon Total	A	A
SiriusXM® Radio³	A	S	Manual-Folding Mirrors	S	N/A	Exhaust Brake	S	S
Bluetooth⁴	A	S	Heated Power-Adjustable Mirrors	A	S	StabiliTrak®	S	S
Cruise Control	S	S	Chrome Mirror Caps	A	A	Locking Rear Differential	A	A
Power Door Locks	S	S	Black 19.5" Steel Wheels	S	S	Limited-Slip Rear Differential	A	A
Remote Keyless Entry⁵	A	S	Gray 19.5" Steel Wheels	A	A	Air Compressor Accessory Drive	A	A
OnStar®⁶	A	S	White 19.5" Steel Wheels	A	A	Air Dryer, Heated	A	A
Built-in Wi-Fi® Hotspot with available data⁷	A	S	Aluminum 19.5" Wheels	A	A	Batteries, Dual 1300 CCA	A	A
Rear Vision Camera⁸	S	S	Electrical Provisions Rear of Cab	A	A	Batteries, Triple 2250 CCA	A	A
40/20/40 Vinyl Front Seat	S	N/A	Electrical Provisions Rear of Frame	A	A	Battery Jump-Start Stud	A	A
40/20/40 Cloth Front Seat	A	S	Recovery Hooks¹⁰	A	A	Front Stabilizer Bar	A	A
Front Bucket Seats	N/A	A	Body-Color Fender Extensions	S	S	Suspension Air Control Valve (2WD)	A	A
Driver and Front Passenger Heated Seats	N/A	A	Backup Alarm	A	A	Trailer Brake Controller	S	S
Leather-Wrapped Steering Wheel	N/A	S	Glass, solar absorbing, tinted	S	S	Trailer Provisions/Wiring Harness	S	S
Steering Wheel Audio Controls	N/A	S				Power Take Off (PTO)	A	A
Remote Start⁹	N/A	A				Transfer Case Skid Plate (4WD)	A	A
						Engine Block Heater	A	A

A - Available
N/A - Not Available
S - Standard

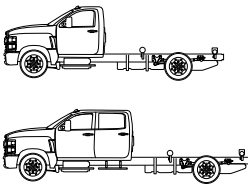

FRAME OPTIONS

CAB CONFIGURATION	CAB-TO-AXLE LENGTH/WHEELBASE — AVAILABLE AXLE-TO-END-OF-FRAME LENGTH (IN INCHES)			
SILVERADO REGULAR CAB CHASSIS CAB	60"/141" (2WD) — 49", 63", 91" (2WD)	84"/165" — 49", 63", 91"	108"/189" — 49", 63", 75"	120"/201" — 49", 63", 75"
	138"/219" — 75"	150"/231" — 91"	162"/243" — 83"	
SILVERADO CREW CAB CHASSIS CAB	60"/175" — 49"	84"/199" — 49", 63"	104"/219" — 75"	120"/235" — 75"

¹Always use seat belts and child restraints. Children are safer when properly secured in a rear seat in the appropriate child restraint. See the vehicle Owner's Manual for more information. ²Not compatible with all devices. ³If you decide to continue service after your trial, your selected subscription plan will automatically renew thereafter. You will be charged at then-current rates. Fees and taxes apply. To cancel you must call SiriusXM at 1-866-635-2349. See SiriusXM Customer Agreement for complete terms at siriusxm.com. All fees and programming subject to change. ©2019 Sirius XM Radio Inc. All rights reserved. ⁴Go to my.chevrolet.com/learnAbout/bluetooth to find out which phones are compatible with the vehicle. ⁵Remote Access Plan does not include emergency or security services. See onstar.com for details and limitations. ⁶See onstar.com for details and limitations. Services vary by model. Service plan required. ⁷Service varies with conditions and location. Requires active service plan and paid AT&T data plan. See onstar.com for details and limitations. Vehicle must be on or in the accessory position for Wi-Fi to function. ⁸Safety or driver assistance features are no substitute for the driver's responsibility to operate the vehicle in a safe manner. Read the vehicle Owner's Manual for important feature limitations and information. ⁹Requires subscription to Remote Access Plan or Unlimited Access Plan. Services are subject to user terms and limitations, and vary by vehicle model. Unlock feature requires automatic locks. Remote start requires GM factory-installed and enabled remote-start system. Visit onstar.com for more details. ¹⁰To avoid the risk of injury, never use Recovery hooks to tow a vehicle. For more information, see the recovery hooks section of your vehicle Owner's Manual.

PAYLOAD & TRAILER WEIGHT RATINGS

MODEL	SERIES	GVWR (LBS.)¹/MAX PAYLOAD (LBS.)²
Silverado Regular Cab Chassis Cab 2WD	4500 HD	14,001/6,494 - 15,000/7,493 - 16,000/8,493 - 16,500/8,993
	5500 HD	17,500/9,993 - 18,000/10,493 - 19,500/11,933
	6500 HD	21,500/13,940 - 22,940/15,380 - 23,500/15,940
	4500 HD	14,001/5,830 - 15,000/6,829 - 16,000/7,829 - 16,500/8,329
Silverado Regular Cab Chassis Cab 4x4	5500 HD	17,500/9,329 - 18,000/9,829 - 19,500/11,269
	6500 HD	21,000/12,686 - 22,500/14,276 - 23,000/14,776
	4500 HD	14,001/5,750 - 15,000/6,749 - 16,000/7,749 - 16,500/8,249
Silverado Crew Cab Chassis Cab 2WD	5500 HD	17,500/9,249 - 18,000/9,749 - 19,500/11,196
	6500 HD	21,500/13,196 - 22,940/14,636 - 23,500/15,196
	4500 HD	14,001/5,187 - 15,000/6,186 - 16,000/7,186 - 16,500/7,686
Silverado Crew Cab Chassis Cab 4x4	5500 HD	17,500/8,686 - 18,000/9,186 - 19,500/10,693
	6500 HD	21,000/12,193 - 22,500/13,693 - 23,000/14,193

GROSS COMBINED WEIGHT RATINGS³

GCWR MAX (LBS.)	26,000	30,000	34,000	35,000	37,000
Rear Axle Ratio	4.10	4.10			
Allison® Transmission Series	1,700/2,700	1,750/2,750			
Rear Axle Capacity	10K - 15.5K	10K - 15.5K			
Rear Axle Ratio	4.30	4.30	4.30		
Allison Transmission Series	1,700/2,700	1,750/2,750	1,750/2,750		
Rear Axle Capacity	10K - 15.5K	10K - 13.5K	15K - 15.5K		
Rear Axle Ratio	4.56	4.56		4.56	
Allison Transmission Series	1,700/2,700	1,750/2,750		1,750/2,750	
Rear Axle Capacity	10K - 15.5K	10K - 13.5K		15K - 15.5K	
Rear Axle Ratio	4.88	4.88			4.88
Allison Transmission Series	1,700/2,700	1,750/2,750			1,750/2,750
Rear Axle Capacity	10K - 15.5K	10K - 13.5K			15K - 15.5K

AXLE RATIOS

4.10 Rear Axle Ratio (2WD)
4.30 Axle Ratio (Standard 4WD/Available 2WD)
4.56 Rear Axle Ratio (2WD)
4.88 Rear Axle Ratio (2WD)

FRONT AXLES

6,250 lb. Front Axle (2WD Reg Cab)
7,000 lb. Front Axle (2WD)
7,500 lb. Front Axle (4WD) (Front Driving)
8,000 lb. Front Axle (2WD)

REAR AXLES

10,000 lb. Rear Axle
11,000 lb. Rear Axle
13,500 lb. Rear Axle
15,000 lb. Rear Axle
15,500 lb. Rear Axle

REAR SUSPENSIONS

11,000 lb. Rear Suspension
13,500 lb. Rear Suspension
15,500 lb. Rear Suspension
12,000 lb. Rear Air Suspension (2WD)
13,500 lb. Rear Air Suspension (2WD)
15,500 lb. Rear Air Suspension (2WD)

REGULAR CAB — SEATING FOR UP TO 3

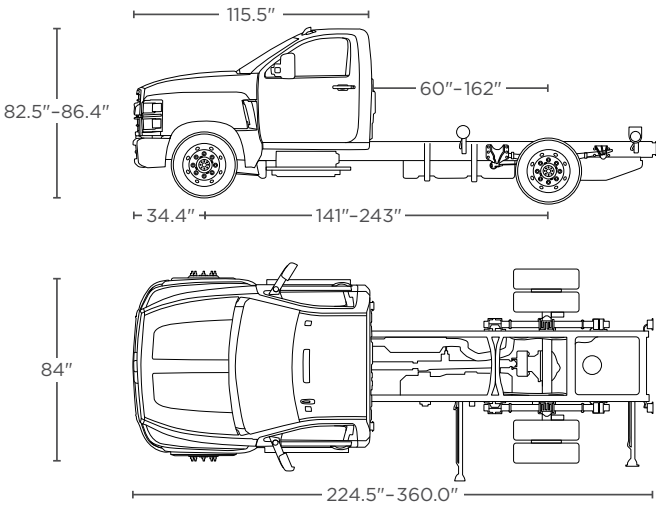

CREW CAB — SEATING FOR UP TO 6

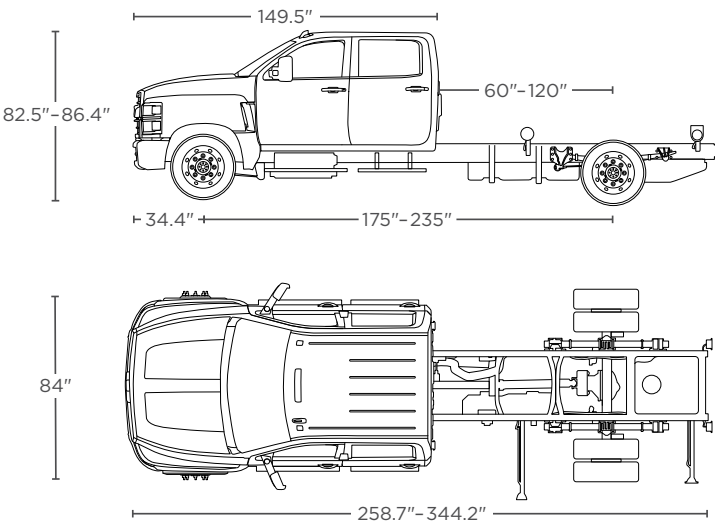

TO LEARN MORE VISIT
gmfleet.com/chassiscab

¹Maximum Gross Vehicle Weight Rating (GVWR). When properly equipped; includes weight of vehicle, passengers, cargo and equipment. ²These maximum payload ratings are intended for comparison purposes only. Before you buy a vehicle or use it to haul people or cargo, carefully review the vehicle loading section of the Owner's Manual and check the carrying capacity of your specific vehicle on the label on the inside of the driver's doorjamb. ³Determine the GCWR for your vehicle. The GCWR is the total allowable weight of the completely loaded vehicle and trailer including any passengers, cargo, equipment and conversions. You should not exceed the GCWR of your vehicle when you tow a trailer. Specifications are subject to change without notice. While due caution has been exercised in the production of this document, possible errors and omissions are unintentional. ©2021 General Motors, LLC. All rights reserved.

FLEET SUPPORT

LIMITED WARRANTY

We stand behind every vehicle we offer with outstanding warranty coverage and exceptional customer service from our more than 300 dedicated fleet staff, because we don't succeed unless you do.

LIMITED ENGINE WARRANTY¹
5 YEARS / 100,000 MILES

LIMITED TRANSMISSION WARRANTY¹
UP TO 5 YEARS / UNLIMITED MILES

LIMITED CHASSIS WARRANTY¹
3 YEARS / 36,000 MILES

DEALER NETWORK

A nationwide Chevrolet medium-duty dealer network ready to meet your fleet's needs with quality service and a full lineup of Chevrolet cars, trucks and SUVs.

FLEET ACTION CENTER

Dedicated Fleet Action Center with experts available to answer any questions or respond to any concerns with your fleet vehicles.

CALL
1.800.FLEETOP

¹Whichever comes first. See dealer for limited warranty details.

