



INTERNATIONAL TRANSTAR DC-400

RATINGS

MAXIMUM GROSS VEHICLE WEIGHT	28,600 lbs.
MAXIMUM GROSS COMBINATION-WEIGHT	80,000 lbs.

STANDARD EQUIPMENT

AXLE, FRONT

FA-139 12,000 lb capacity centre tread
Heat treated forged steel I-beam

AXLE, REAR

RA-57 23,000 lb. capacity
Single reduction, hypoid gear
One-piece forged steel housing
Full floating induction hardened axle shafts
Ratio: 4.44:1

BRAKES, PARKING

Spring actuated, piggy-back, mounted on rear axle brake chambers
Dash controlled air release
Additional 462 cu. in. reservoir for emergency release
Total lining area: 475 sq. in.

BRAKES, SERVICE

Air, with 12 cu. ft. water cooled compressor, air intake through engine air cleaner
Two air reservoirs, 3,265 cu. in. total capacity
Size: front, 15 x 3½ in. wedge type; rear, 16½ x 7 in. S-cam type
Total lining area: 710 sq. in.
Low pressure warning light and buzzer
Front wheel limiting valve
Semi-trailer connections with breakaway and hand control valves; trailer kit with 14 ft. hose

CAB

Welded steel construction
Safety glass windows and tinted windshield
Bostrom "West Coaster" driver's seat; tool box on right side
Foam rubber passenger seat
Two fresh-air intakes; dual sun visors; ash tray
Heavy duty rubber floor mat with insulated backing
Vinyl plastic headliner and back panel
Air operated windshield wipers with dual motors

CAB (continued)

Dual rear view mirrors
Chrome grab handles
Gauges: voltmeter, fuel level, water temp., engine oil temp., air pressure, oil pressure; speedometer, odometer and tachometer
Bonnet and mudguards: one-piece forward-tilting fibreglass
Electric windshield washers
Dual chrome air horns

CLUTCH

14-inch 2-plate with clutch brake
Total lining area: 423 sq. in.

COOLING SYSTEM

43-quart capacity
Three-piece bolted radiator with de-aeration system; 1003 sq. in. frontal area
Air operated automatic radiator shutters

DRIVE LINE

4 in. dia. dynamically balanced shafts
Spicer 1700 series needle bearing joints

ELECTRICAL SYSTEM

12 volt, 62 amp alternator
Fully transistorized regulator
Four 6-volt, 150 amp. hr. batteries
Dome light, cigarette lighter
Rheostat controlled instrument panel lights
High beam and turn signal indicator lights
Front directional signals, double face, fender mounted with side reflectors and lamps
Rear directional signals
Two front clearance and three identification lamps
Dual stop and tail lamps; back-up light; parking lights
Electric horn; traffic hazard switch

ENGINE

Cummins NHC-250 6 cylinder diesel
Gross B.H.P.: 250.0 @ 2,100 RPM

ENGINE (continued)

Gross torque: 686.0 lb. ft. @ 1,500 RPM
Displacement: 855.0 cu. in.
Compression ratio: 15.3 to 1
Full flow oil filter with additional 23-pint bypass filter
Engine water filter and corrosion resistor
Heavy duty dry-type air cleaner with depression indicator
R.A.C. taxable horsepower: 72.5

FRAME

Heat-treated chrome molybdenum steel channel main rails
Bolted construction, drop front end section, straight to rear. 9¼ x 3-7/16 x ¼ in.
Section modulus: 11.54 in. cubed
Formed steel front safety bumper

FUEL TANKS

Left 67 gal., right 83 gal.

STEERING

S-270 integral power steering with 21 in. dia. wheel

SUSPENSION

Front: 11,300 lb. total capacity steel leaf springs, semi-elliptical 4 x 54 in.
Threaded pins and bushings
Hydraulic double-acting shock absorbers
Rear: 23,000 lb. steel leaf springs total capacity
3 x 46 in. variable rate

TRANSMISSION

T-129 Fuller RT-910 10-speed direct, twin countershaft Roadranger
Ratios: 8.05, 6.30, 4.99, 3.95, 3.20, 2.51, 1.97, 1.56, 1.24, 1.00 to 1
Reverse: 8.73, 2.73 to 1.

WHEELS AND TYRES

Single front and duals rear
10.00 x 20 12-ply tyres
Cast steel spoke wheels with 7.50V rims

DIMENSIONS AND WEIGHTS

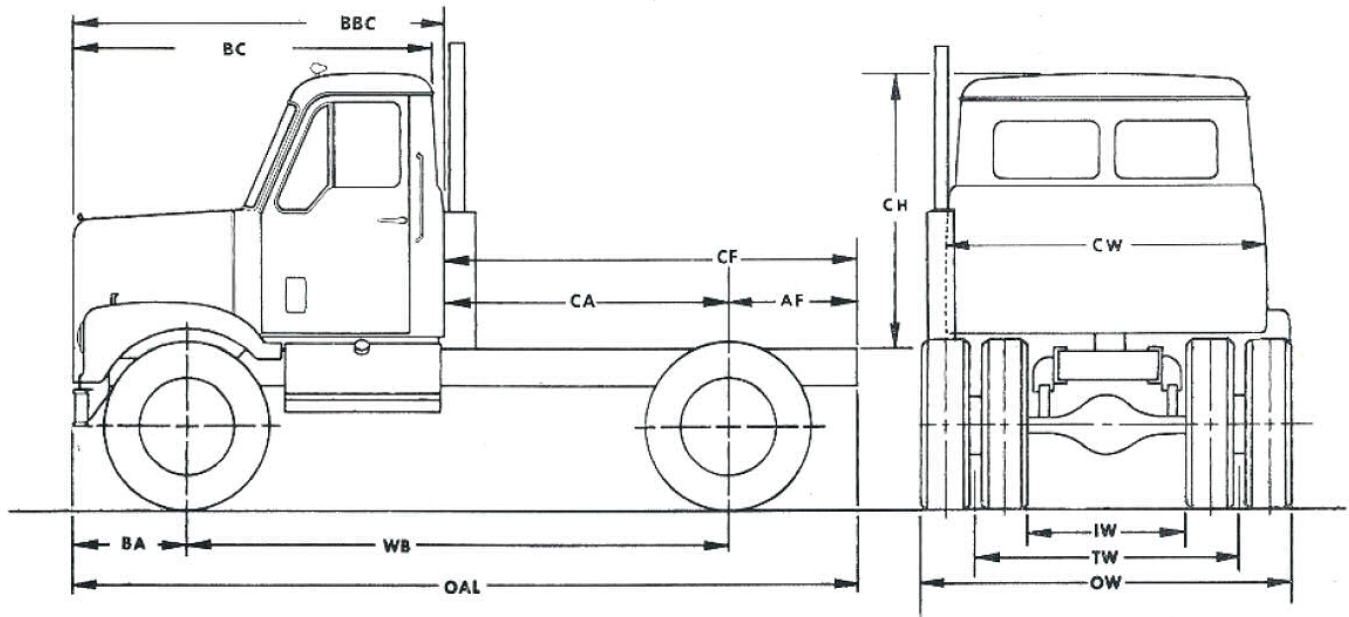

Dimensions with 10.00 x 20 tyres (ins.)

Frame height—rear axle—empty: 40.25	Overall width — front bumper: 95.5	Tread width (TW)—	
—loaded: 37.25	Overall height — top of cab: 107.0	front: 79.5	rear: 72.0
Ground clearance — front axle: 11.25	Outside width, tyres (OW): 95.5	Inside width (IW):	48.5
Ground clearance — rear axle: 8.87			

Chassis dimensions and weights

Dimensions (inches)										Turning radius		Chassis weights (lbs.) *		
WB	BBC	BC	BA	CH	CW	CA	CF	AF	OAL	To Centreline of Tyre	With bumper clearance	Front	Rear	Total
164	92	89	28.5	66	85	100.5	132.5	32	224.5	33 ft. 2 in.	34 ft. 11 in.	7,500	4,600	12,100

* Weights are estimated and include standard tyres, oil, water and fuel (full tank).

In order that product improvements may be introduced at any time, specifications are subject to change without notice.

Illustrations may include optional equipment.

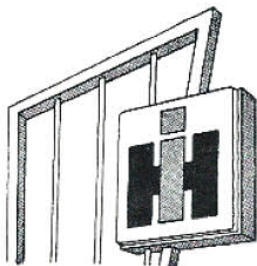

The sign of quality and service