

N I N E T Y N I N E

Oldsmobile



C O N T E N T S	2	A L E R O
	8	I N T R I G U E
	12	A U R O R A
	16	C U T L A S S
	20	E I G H T Y E I G H T
	24	5 0 T H A N N I V E R S A R Y E I G H T Y E I G H T
	26	L S S
	28	S I L H O U E T T E
	34	B R A V A D A
	38	S P E C I F I C A T I O N S

A ROAD WORTH TRAVELING.

EVERY 1999 OLDSMOBILE WAS CREATED TO AWAKEN YOUR JOY OF DRIVING. AND INSTILL A SENSE OF ASSURANCE THAT MAKES YOU FEEL THAT ANY ROAD IS A ROAD WORTH TRAVELING. THANKS TO INNOVATIVE DESIGN AND ENGINEERING, OLDSMOBILE NOW PRESENTS A COMPLETE PORTFOLIO OF VEHICLES, ALL AIMED AT ENHANCING YOUR ON-ROAD EXPERIENCE. EVERY MODEL SURROUNDS YOU WITH SOPHISTICATION AND REFINEMENT, INSPIRES A NEW LEVEL OF DRIVING CONFIDENCE AND CONTROL. WITH HARMONIOUS INTERIORS, CLEAN, SOPHISTICATED STYLING, AND SMOOTH, AGILE PERFORMANCE. WHEN WAS THE LAST TIME A CAR FELT SO RIGHT — AND YOU FELT SO CONNECTED TO THE ROAD? THINK ABOUT IT. YOU'RE THINKING OLDSMOBILE.

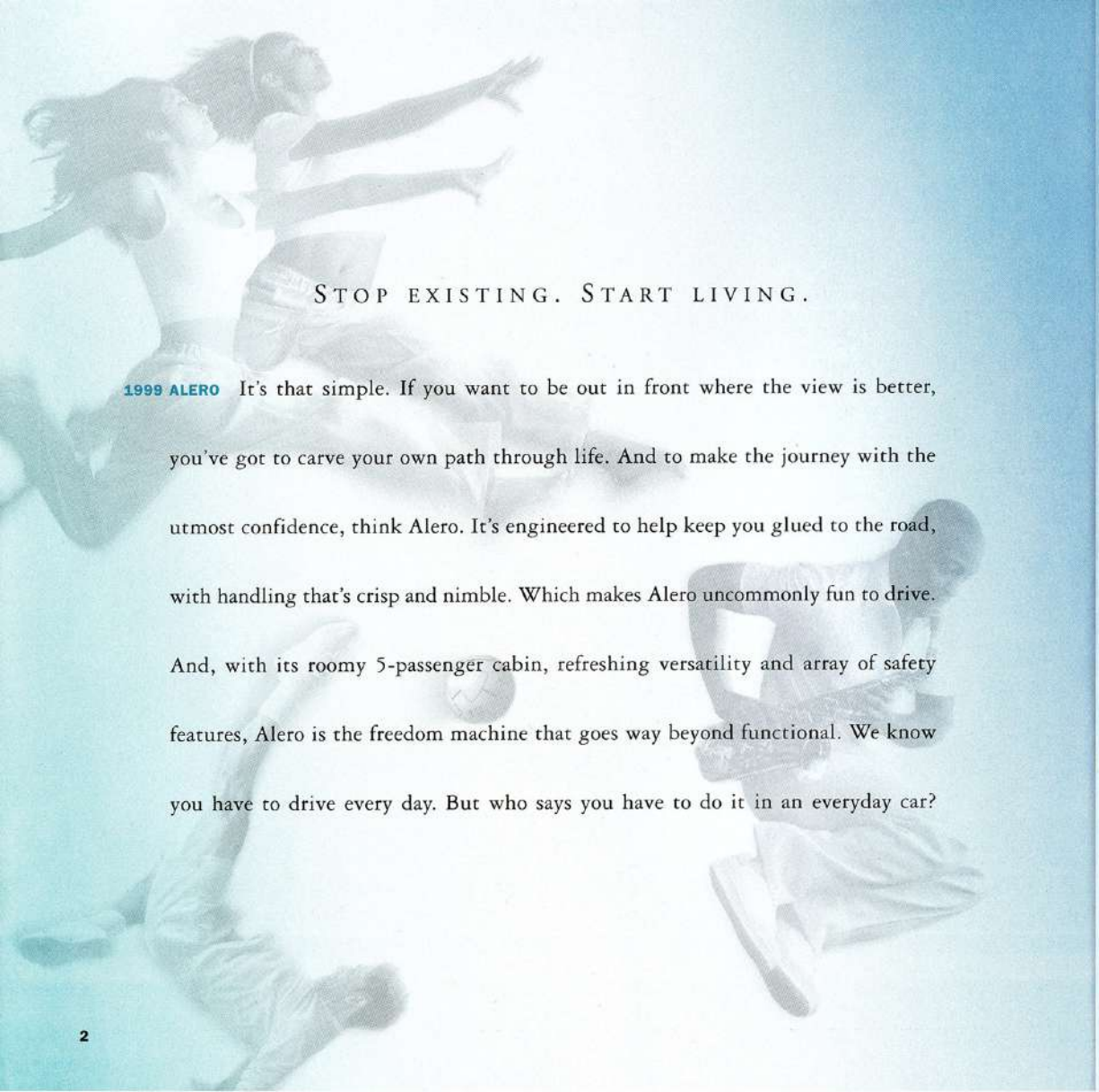

STOP EXISTING. START LIVING.

**1999 ALERO** It's that simple. If you want to be out in front where the view is better, you've got to carve your own path through life. And to make the journey with the utmost confidence, think Alero. It's engineered to help keep you glued to the road, with handling that's crisp and nimble. Which makes Alero uncommonly fun to drive. And, with its roomy 5-passenger cabin, refreshing versatility and array of safety features, Alero is the freedom machine that goes way beyond functional. We know you have to drive every day. But who says you have to do it in an everyday car?



START

THIS



Alero GLS Sedan in Silver Mist.

1999 ALERO

Driving is an activity that should be done for the fun of it, even if you're going nowhere in particular. It's easy in Alero's relaxed and stress-free atmosphere. The light and airy passenger cabin, with its two-tone color scheme and expansive glass area, opens the space and lets in the sun. And when Alero hits the curves, the fun really starts. This is when the Active Response System does its best work, with 16 features working together to help you feel more connected to the road. Add a responsive engine that's as smooth as a whipped cream water slide, and Alero's message to you is crystal clear. Stop commuting. Start driving.



Driving is more fun when you're backed by the confidence of standard safety and security features like all-speed traction control, 4-wheel antilock disc brakes, a theft-deterrent system, battery-rundown protection and a rigid safety-cage construction with front and rear crush zones. It's a combination you won't find standard on most competitive vehicles.



Alero's spacious interior combines sweeping contours with the comfort of leather-trimmed seats, available in GL models and standard in GLS.

IT DOESN'T JUST HUG THE ROAD. IT SEDUCES IT.

**1999 INTRIGUE** One look at Intrigue tells you this is a car that turns heads as well as it turns corners. Its jewel-like headlamps and sculpted contours whisper sophistication. But underneath its sleek body, its soul yearns for pure driving pleasure. Got a twist you're trying to straighten? The precision tools you need are all here: a rigid body structure, large 4-wheel disc antilock brakes, a patented magnetic variable-assist steering system, available traction control, and an agile suspension designed exclusively for Intrigue. Perhaps this explains why *Automobile Magazine* said, "We found ourselves leaning on Intrigue in the corners as if it were a BMW or Mercedes." Maybe. Or maybe it's what's under the hood.





Intrigue GL with leather-trimmed seating in Neutral. Shown with available equipment.

## 1999 INTRIGUE

Slip inside, and you'll soon understand why we say Intrigue is a sophisticated twist on a sports sedan. Start the engine, and you'll hear the free-revving sounds of state-of-the-art technology and meticulous craftsmanship. For 1999, Intrigue is available with a new 3.5-liter twin-cam V6 engine that delivers the responsive rush of 215 horsepower when you need it most — on the highway. Designed and tuned exclusively for Intrigue, this innovative powerplant was derived from Aurora V8 technology and benefited from the most extensive computer testing in our history. The result? An aluminum construction that translates directly into smooth precision and enhanced driving confidence.



It comfortably seats five, but Intrigue was designed around you — the driver. The instrument panel arcs gracefully to present gauges and controls. Comfortable, supportive seats and the sensuous feel of available leather trim invite you to tune your senses to the spirit of the road.



Twin-tube struts with 4-stage valving were engineered exclusively for Intrigue. They provide precise control and quick response.



Intrigue's available new 3.5L twin-cam V6 serves up responsive power at all speeds, and its 230 lb-ft of torque offers more punch than any competitive DOHC V6 engine in the class.\*

\*Based on 1998 Model Year competitive vehicles.

A PERSONALITY AS UNIQUE AS ITS DRIVER.

**1999 AURORA** Think of Aurora as the luxury car that's as much of an individual as you are.

Just like all individuals, Aurora has its own unique DNA. And just like you, it has its own personal interpretation of luxury. Its bold styling doesn't rely on outdated preconceptions or borrowed philosophies. It's a fresh look at luxury and a novel interpretation of performance. You could define it as luxury without the stuffy tradition. And performance with passion — but without the melodrama. Frankly, we didn't create Aurora to please everyone. But if you're ready to go your own way, it may be the perfect luxury car for you.







1999 AURORA

Aurora carries its elegance with an easy grace. It doesn't overstate its case with upright hood emblems or faux grilles that serve no function. Instead, you'll find sophisticated design that brings the exterior and interior into harmony. A powertrain that combines smoothness and power in equal measure. And a cabin so well tailored in leather and burled walnut trim, and so fully equipped, that only a handful of options are available. Beyond the wealth of features and the advanced engineering you'll find in every component, Aurora provides you with something else. An undeniable sense of gratification you'll feel knowing that you're not following the herd instinct.



Aurora's DOHC V8 engine is as smooth as it is powerful. Its 250 horsepower is unleashed at the slightest encouragement from the driver. And with 90 percent of peak torque available from 1200 to 5600 rpm, the engine instantly comes alive for passing maneuvers or confidently taking a steep hill in stride.

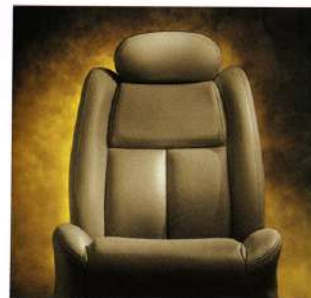

Relentless research has yielded what might be the industry's most comfortable seat. It features a standard 8-way power adjustment, and the driver's-seat memory function can store and recall two different seat and outside mirror settings at the touch of a button.

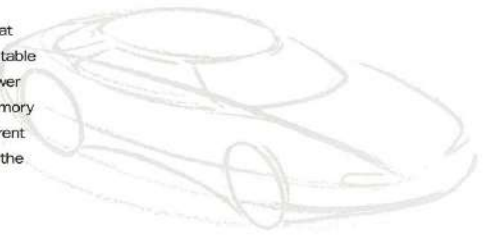

SO WELL EQUIPPED, IT'S AMAZING EVERYTHING FITS.

**1999 CUTLASS** When we designed Cutlass, we set out to create the most user-friendly sedan on the market. Like building the proverbial ship in the bottle, we managed, through meticulous engineering and well-thought-out design, to create a highly detailed and extremely comfortable interior within the confines of the body. Slide into the driver's seat — or any of the five comfortable spots inside — and you'll probably have the same reaction you did when you first saw a ship in a bottle. How did they do that? The answer is: very carefully. One component at a time. And the result is a functional yet refined sedan that makes life behind the wheel just a little more enjoyable.





Cutlass GLS in Bronze Mist. Shown with available Gold Package.

## 1999 CUTLASS

Are you a big picture person? Or the detail-oriented type? Either way, Cutlass has you covered. With features like a responsive V6 engine, 4-speed automatic transmission and 4-wheel antilock brakes — all standard, so you don't have to pay extra. In the GLS, there's even the luxury of leather trim, a 6-way power driver's seat and remote-control keyless entry. As for details, you'll be amazed at the clever thinking that went into Cutlass. From something as simple as putting cruise control functions right on the steering wheel, to offering a built-in pen holder in the center console. We even thought of putting a cupholder in the typically under-utilized space to the left of the steering wheel. Now that's clever.



Designed for 5-passenger comfort, Cutlass offers an efficient interior with an abundance of clever details, like the ergonomically angled shifter and accessible dash-mounted ignition. Cutlass adds one more feature to make life a little more luxurious: standard leather-trimmed seats in the GLS model.



Powerful and efficient, the standard 3100 SFI V6 engine is a model of smoothness and refinement.



Cutlass' split-folding rear seats with a trunk pass-through make it easy to carry longer items and still comfortably accommodate a rear passenger.

ENDURING VISION STANDS THE TEST OF TIME.

**1999 EIGHTY EIGHT and LSS** In 1949, Oldsmobile launched a rocket. Called the Eighty Eight, it was an automobile that single-handedly set new benchmarks for style and performance. Five decades of innovation later, the Eighty Eight remains true to its roots, offering enduring design, proven performance and lasting value. For 1999, Oldsmobile is proud to offer its impressive full-size sedans: the refined and spacious Eighty Eight, the new fully equipped 50th Anniversary Edition Eighty Eight, and the performance-oriented LSS. All three models are thoroughly modern expressions of classic automotive value.

EST. 1949



Eighty Eight in Champagne.



Eighty Eight with cloth-trimmed seating in Neutral.

## 1999 EIGHTY EIGHT

Eighty Eight's time-tested quality and value offer lasting appeal. With sound engineering that can be described in one word — dependable. A pretty powerful word when you consider it's backed by the sure-footed stability of front-wheel drive, the directional control of 4-wheel antilock brakes, and the smooth ride of a 4-wheel independent suspension. Inside Eighty Eight, you'll find spacious seating for six and easy-to-use controls, as well as standard amenities like air conditioning, power accessories and a Dimensional Sound audio system. Continually improved upon within a strict criterion of quality, Eighty Eight remains the standard for exceptional value in full-size sedans.



Eighty Eight features a divided-bench front seat and stretch-out seating for six. The LS model offers the comfort of standard front bucket seats with an integrated center storage console, and the luxury of available leather trim.



Eighty Eight has been honored with a *Consumers Digest* full-size "Best Buy" award for eight years in a row.\*



Standard power window and door lock controls are conveniently close at hand. Power outside mirrors are standard on Eighty Eight LS.

\*The Best Buy emblem is a registered trademark of Consumers Digest Inc., used under license.



50th Anniversary Edition Eighty Eight in Black Onyx.

50TH ANNIVERSARY EDITION EIGHTY EIGHT

This year marks the 50th year Eighty Eight has been on the road, and Oldsmobile commemorates this special occasion with the ultimate in grace and comfort — the 50th Anniversary Edition Eighty Eight. To honor a history of fine craftsmanship, it includes many choice standard features, such as: leather-trimmed seating, CD/cassette combination stereo, 8-way power front seats with driver's-side dual memory controls and dual-zone climate control. This exceptional, fully equipped model exemplifies a tradition of timeless, straightforward design that has long been an Eighty Eight standard.



Inside the quiet, leather-trimmed cabin, you'll find roomy seating for six passengers, plus an array of conveniences and amenities. Exterior gold trim, 16-inch aluminum wheels and remote-control keyless entry with illumination and personalization features further distinguish this commemorative Eighty Eight model.



Oldsmobile's 50th Anniversary Edition Eighty Eight is the embodiment of five decades of full-size sedan luxury.



Steering wheel audio and climate touch controls help keep your eyes on the road and your hands on the wheel, for convenience as well as safety.



LSS in Black Onyx.

1 9 9 9 L S S

You've paid your dues. Now you're ready for a dose of sophisticated sporting style — without forgoing full-size comfort. And with LSS, it starts with performance. Press the throttle and the powerful 205-hp 3800 Series II V6 engine responds with smooth, robust acceleration. The Magnasteer speed-sensitive variable-assist steering system and a sport-tuned suspension offer precise steering and crisp handling. And you'll enjoy the agile ride in the comfort of a spacious cabin with ergonomically designed seating and sleek styling. So, are you starting to forget about all those dues you've paid? We thought you would.



Sit in the sculpted front bucket seats and experience the commanding comfort of support. With gauges front and center, shifter close at hand and the luxury of a leather-wrapped steering wheel, you're ready to appreciate the performance that is about to start.



The standard AM/FM stereo with CD/cassette player combination provides concert-hall richness.



Interested in the ultimate expression of LSS? Then make sure it's supercharged. This available 240-hp V6 offers exhilarating performance that makes the most of LSS' sport-tuned independent suspension.

THE ULTIMATE IN PERSONAL PREFERENCE.

1999 SILHOUETTE Wouldn't life be simpler if everybody liked the same color? Instead, we all want things rendered in our own hues. Fortunately, Silhouette is a minivan that understands all this. It has the ability to please all of its passengers, no matter what their preferences. And an abundance of comforts and conveniences to accommodate your lifestyle. Available features like individualized second-row captain's chairs, rear climate and audio controls, and the first factory-installed video entertainment system, help to ensure everyone is taken care of. So no matter where you go, you can paint your world exactly the way you wish.







Silhouette GLS with leather-trimmed seating in Beige.



Silhouette Premiere video entertainment system

Silhouette supplies the features that satisfy everyone's needs. Like standard dual sliding side doors, an available passenger-side power sliding door, and enough built-in flexibility to accommodate whatever life brings your way. And for the ultimate in personal attention, consider the new Silhouette Premiere. It's the first vehicle of its kind to feature an integrated video entertainment system,\* complete with an LCD color monitor for viewing by rear-seat passengers. This unique minivan gives motion pictures a whole new meaning. It's further proof that Silhouette ensures that passengers not only get where they're going in comfort, but enjoy the time spent along the way.



Silhouette's dual sliding doors make it easy to load up the family and go. The available power passenger-side sliding door opens at the touch of a button, so even with arms full, getting everyone's gear on board is a breeze.



Safety starts with a rigid body structure. Silhouette offers "safety-cage" construction, plus front and rear crush zones designed to help protect occupants in the event of a collision. Front seat side-impact air bags offer added security and peace of mind.\*\*

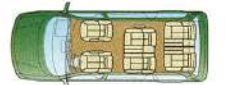

Standard 7-passenger seating



Available 8-passenger seating

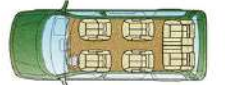

Available 7-passenger seating with captain's chairs

\*Factory installed. May not be available in all states. See your dealer for details.

\*\*Always use safety belts and proper child restraints, even with air bags. Children are safer when properly secured in a rear seat.

AUTOMATIC TRACTION AND FULL-TIME COMFORT.

1999 BRAVADA When you slide behind the wheel for a trip across town or across the state, you never know what to expect. A change in road conditions can turn a simple drive into a challenge. Bravada's automatic SmartTrak system was designed to help you handle the unexpected. SmartTrak operates in 2-wheel drive under normal driving conditions. But when it senses wheelspin, it engages all-wheel drive within  $\frac{1}{4}$  of a second to direct the right amount of power to the wheels with the most traction. When slippage is no longer detected, SmartTrak returns to 2-wheel drive. But while all-wheel drive engages only when necessary, Bravada's comfortable, leather-trimmed interior and carlike ride and handling are with you all the time. They offer a level of attention you might only expect in a premium luxury sedan.





Bravada with leather-trimmed seating in Beige.

Bravada is one sport utility vehicle that even luxury sedans might envy. Its spacious cabin offers stretch-out comfort along with a number of standard features including: leather-trimmed seating, an 8-way power driver's seat, power front-seat lumbar supports, automatic electronic climate control and 6-speaker CD/cassette combination stereo. And to complement these conveniences, Bravada also features a functional overhead console with an electronic compass, trip computer, outside temperature readout, front and rear reading lamps, and a HomeLink® Universal Transmitter. Bravada's well-designed suspension provides easy handling and a refined ride that will assuredly make premium sedans sit up and take notice.



Bravada's muscular 4.3-liter Vortec V6 offers smooth running, 190-hp performance for effortless city driving or highway cruising. Its 250 lb-ft of torque provides plenty of confidence on uphill grades.

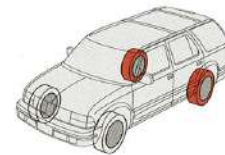

Normal Driving Conditions  
2-Wheel Drive

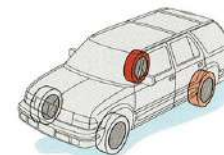

Side-to-side Slippage  
2-Wheel Drive

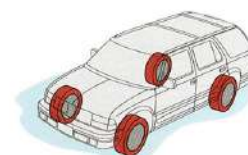

Front-to-rear Slippage  
All-wheel Drive

SmartTrak operates in 2-wheel drive under normal driving conditions. When it senses wheel slippage, it automatically directs power to the wheels with the most traction. Controlled through the combined efforts of an active transfer case, locking rear differential and 4-wheel disc antilock brakes, SmartTrak is automatic. You don't have to pull any levers or push any buttons.



## STANDARD FEATURES

## SAFETY AND SECURITY

Next Generation dual frontal air bags\* • 4-wheel antilock brakes • All-speed traction control system • Automatic power door locks • Vehicle security system • Daytime running lamps with automatic headlamp control • Variable-intermittent wipers • Battery-rundown protection

## POWERTRAIN

2.4-liter DOHC 4-cylinder engine (GX and GL) and 3.4-liter V6 engine (GLS) with 100,000-mile platinum-tipped spark plugs and 150,000-mile coolant<sup>1</sup> • Electronic 4-speed overdrive automatic transmission with 100,000-mile fluid<sup>1</sup> • Front-wheel drive

## CHASSIS AND SUSPENSION

4-wheel independent suspension: strut-type with front aluminum lower control arms and rear "tri-link" semi-trailing arms, coil springs, gas-charged struts with deflected disc valving and stabilizer bars • Power rack-and-pinion steering • Power 4-wheel disc brakes

## DRIVER CONTROLS

Analog instrument cluster with tachometer and gauges for coolant temperature and fuel level • Electronic trip odometer and oil change monitor • Dash-mounted ignition and hazard switches • Center console with floor shifter and traction system on/off switch • 4-spoke steering wheel with TILT-Wheel adjustable column

## SEATING AND TRIM

Reclining contour front bucket seats with side bolsters • Split-folding rear seatback • Storage: center console storage bin, driver's personal compartment, locking glove box, overhead storage bin, front and rear cupholders, and map pockets in front doors (GL and GLS) and front seatbacks

## COMFORT AND CONVENIENCE

Air conditioning with rear-seat heat ducts • AM/FM stereo with extended-range sound system and separate AM and FM rear-window antennas • Reading lamps • Illuminated entry/exit system with theater dimming • Lighted visor vanity mirrors • Power trunk release

## EXTERIOR

Faceted reflector lighting • Tinted glass with UV protection • Dual spring-loaded outside mirrors • 5-mph front and rear bumpers • Dent-resistant doors, fenders and hood • Gas-charged hood struts

## AVAILABLE FEATURES

SEATING AND TRIM	GX	GL SEDAN	GL COUPE	GLS
Cloth-trimmed seating areas	S	S	S	A
Leather-trimmed seating areas (Neutral only)	—	A	A	S
Leather-wrapped steering wheel and shift handle	—	A	S	S
Driver's seat with power height adjustment	A	S	S	—
6-way power driver's seat	—	A	A	S
COMFORT AND CONVENIENCE				
Remote-control keyless entry with panic button	—	A	A	S
Cruise control with steering wheel-mounted functions	A	S	S	S
Power windows and outside mirrors	—	S	S	S



## AVAILABLE FEATURES (CONTINUED)

AUDIO SYSTEMS	GX	GL SEDAN	GL COUPE	GLS
AM/FM stereo with cassette player	A	S	S	—
AM/FM stereo with CD/cassette player combination	A	A	A	S
100-watt Dynamic Bass Audio System	—	A	A	A

## EXTERIOR

Power sunroof with sliding glass panel	—	A	A	A
Rear decklid spoiler	—	A	A	A
Foglamps	—	A	S	S
15-inch aluminum-alloy wheels (Silver)	—	A	S	—
P215/60R15 all-season radial touring tires	S	S	S	—
16-inch aluminum-alloy wheels (Silver)	—	A	A	—
16-inch aluminum-alloy wheels (Polished)	—	—	—	S
P225/50R16 radial touring tires	—	A	A	S

## POWERTRAIN/CHASSIS

2.4-liter DOHC 4-cylinder engine	S	S	S	—
3.4-liter V6 engine	—	A	A	S
Performance suspension package	—	—	—	A
Variable-effort rack-and-pinion steering	—	S	S	S
S Standard	A Available	—	—	Not available

## SPECIFICATIONS

ENGINE	2.4-LITER DOHC 4-CYLINDER	3.4-LITER V6
Displacement	2.4 liters (146 cu in)	3.4 liters (207 cu in)
Horsepower	150 @ 5600 rpm	170 @ 4800 rpm
Torque (lb-ft)	155 @ 4400 rpm	200 @ 4000 rpm
Fuel delivery	Sequential port fuel injection	

EXTERIOR DIMENSIONS	SEDAN	COUPE
Wheelbase (in)	107.0	107.0
Length (in)	186.7	186.7
Width (in)	70.1	70.1
Height (in)	54.5	54.5
Curb weight (lb)	3077	3026

INTERIOR DIMENSIONS	SEDAN	COUPE
Headroom, front/rear (in)	38.4/37.0	38.4/36.5
Legroom, front/rear (in)	42.2/35.6	42.2/35.6
Shoulder room, front/rear (in)	53.6/52.6	53.6/54.6

CAPACITIES	SEDAN	COUPE
Passenger capacity	5	5
Trunk volume (cu ft)	15.3	15.3
Fuel (gal)	15.0	15.0

\*Always use safety belts and proper child restraints, even with Next Generation air bags. See the owner's manual for more safety information.  
<sup>1</sup>Maintenance needs vary with use and driving conditions. See your owner's manual for more information.



## STANDARD FEATURES

## SAFETY AND SECURITY

Next Generation dual frontal air bags • 4-wheel antilock brakes • Daytime running lamps with automatic headlamp control • Automatic programmable power door locks • Vehicle security system • Variable-intermittent wipers • Battery-rundown protection

## POWERTRAIN

3800 Series II V6 engine with enhanced traction system (GX and GL) and 3.5-liter twin-cam V6 engine (GLS) with 100,000-mile platinum-tipped spark plugs and 150,000-mile coolant\* • Electronic 4-speed overdrive automatic transmission with 100,000-mile fluid\* • Front-wheel drive

## CHASSIS AND SUSPENSION

4-wheel independent suspension: strut-type with front lower control arms and rear "tri-link" semi-trailing arms, coil springs, gas-charged struts and stabilizer bars • Magnasteer variable-assist steering • Power 4-wheel disc brakes • 16-inch aluminum wheels • P225/60R16 touring radial tires

## DRIVER CONTROLS

Analog instrument cluster with tachometer and gauges for coolant temperature and fuel level • Electronic trip odometer and oil change monitor • Dash-mounted ignition and hazard switches • Floor shifter • Cruise control with steering wheel-mounted functions • TILT-Wheel adjustable steering column

## SEATING AND TRIM

Reclining contour front bucket seats • "Theater-style" rear bench seat with folding armrest • Storage: front console armrest, locking glove box, dual front and rear cupholders, and map pockets in doors and front seatbacks • Passenger-assist handles

## COMFORT AND CONVENIENCE

Air conditioning with rear-seat heat ducts • AM/FM stereo with cassette player, extended-range sound system and rear-window antenna • Power windows, door locks and outside mirrors • Illuminated entry/exit system with theater dimming • Auxiliary power outlet

## EXTERIOR

Faceted reflector lighting • Cornering lamps • Tinted glass with solar-control windshield and rear window • Fold-away power outside mirrors • Gas-charged hood and trunk struts

## AVAILABLE FEATURES

SEATING AND TRIM	GX	GL	GLS
Leather-trimmed seating areas	—	A	S
Leather-wrapped steering wheel and shifter handle, plus leather-covered center armrest	A	S	S
6-way power driver's-side seat	A	S	S
6-way power front passenger's seat	—	—	S
60/40 split-folding rear seatback	A	S	S
Faux woodgrain interior accents	—	—	S

## AVAILABLE FEATURES (CONTINUED)

COMFORT AND CONVENIENCE	GX	GL	GLS
Automatic dual-zone climate control system	—	S	S
Air filtration system	A	A	A
Remote-control keyless entry system with panic button	A	S	S
Steering wheel audio touch controls	—	A	S
Electrochromic inside rearview mirror with compass	—	—	S
OnStar communications system (dealer installed)	A	A	A

## AUDIO SYSTEMS

Delco ETR AM/FM stereo with CD/cassette player combination and 6-speaker Dimensional Sound system	A	A	S
BOSE® Audio System: AM/FM stereo with CD/cassette player combination and amplified 8-speaker sound system	—	A	A
Trunk-mounted 12-disc CD changer	A	A	A

## EXTERIOR

Power sunroof with tilting/sliding glass panel	A	A	A
Body-color heated outside foldaway mirrors and foglamps	—	S	S
Decklid spoiler	A	A	A
Chrome wheels	—	A	A

## POWERTRAIN/CHASSIS

3.5-liter twin-cam V6 engine	A	A	S
Full-range traction control system	—	A	S
Autobahn Package: Larger front brakes and high-speed tires	—	A	A
S Standard	A Available	—	Not available

## SPECIFICATIONS

ENGINE	3800 SERIES II V6	3.5-LITER TWIN-CAM V6
Displacement	3.8 liters (231 cu in)	3.5 liters (212 cu in)
Horsepower	195 @ 5200 rpm	215 @ 5500 rpm
Torque (lb-ft)	220 @ 4000 rpm	230 @ 4400 rpm
Fuel delivery	Sequential port fuel injection	

EXTERIOR DIMENSIONS	SEDAN
Wheelbase (in)	109.0
Length (in)	195.9
Width (in)	73.6
Height (in)	56.6
Curb weight (lb)	3455

INTERIOR DIMENSIONS	SEDAN
Headroom, f/r (in)	39.3/37.4
Legroom, f/r (in)	42.4/36.9
Shoulder room, f/r (in)	58.0/57.0

CAPACITIES	SEDAN
Passenger capacity	5
Trunk volume (cu ft)	16.3
Fuel (gal)	17.0

\*Maintenance needs vary with use and driving conditions. See your owner's manual for more information.

1999 EIGHTY EIGHT



**STANDARD FEATURES**

**SAFETY AND SECURITY**

Next Generation dual frontal air bags • 4-wheel antilock brakes • Vehicle security system • Daytime running lamps with Twilight Sentinel automatic headlamp control • Power door locks • Variable-intermittent wipers • Battery-rundown protection

**POWERTRAIN/CHASSIS AND SUSPENSION**

3800 Series II V6 engine with 100,000-mile platinum-tipped spark plugs and 150,000-mile coolant\* • Electronic 4-speed overdrive automatic transmission with 100,000-mile fluid\* • Front-wheel drive • 4-wheel independent suspension • Power rack-and-pinion steering • Power brakes

**DRIVER CONTROLS**

Analog gauge cluster with tachometer • Cruise control • TILT-Wheel adjustable steering column • Remote driver's outside mirror

**SEATING AND TRIM**

55/45 divided-bench front seat • 8-way power driver's-side seat • Storage: front armrest with cupholders, locking glove box, and map pockets in front doors and front seatbacks • Passenger-assist handles • Deluxe trunk trim

**COMFORT AND CONVENIENCE**

Air conditioning • AM/FM stereo Dimensional Sound system with cassette player • Power windows with driver's-side auto-down • Front and rear reading lamps • Dual vanity mirrors (lighted on LS and Anniversary Edition)

**EXTERIOR**

Halogen headlamps • Tinted glass with solar-control windshield and rear window • Body-color outside mirrors • Power antenna • 15-inch wheels (wheel covers on Eighty Eight, aluminum wheels on LS) • 16-inch aluminum wheels (50th Anniversary Edition)

**AVAILABLE FEATURES**

SAFETY AND SECURITY	EIGHTY EIGHT	LS	50TH ANNIV.
Electronic full-range traction control	—	S	S
Foglamps	—	S	—
Remote-control keyless entry with panic button	A	S	S
Dual power outside mirrors	—	S	S
Heated Electrochromic driver's outside mirror	—	—	S
OnStar communications system (dealer installed)	A	A	A

**COMFORT AND CONVENIENCE**

Delco ETR AM/FM stereo with CD/cassette players	—	A	S
Dual-zone climate control system	—	—	S
Steering wheel audio/climate touch controls	—	—	S
Automatic Electrochromic inside mirror with compass	—	—	S

**SEATING AND TRIM**

55/45 divided-bench front seat	S	A	S
Front bucket seats with center floor console	—	S	—
Leather-trimmed seating areas	—	A	S
8-way power passenger-side seat	—	A	S

**EXTERIOR**

Power sunroof with tinted sliding glass panel and sunshade	—	—	A
16 inch aluminum wheels	—	A	S
S Standard	A Available	—	Not available

1999 LSS



**STANDARD FEATURES**

The LSS is a fully equipped model that includes all of the standard equipment of Eighty Eight, plus the following features:

**SAFETY AND SECURITY**

Electronic full-range traction control • Automatic programmable power door locks • Remote-control keyless entry system with panic button • Foglamps • Automatic Electrochromic heated driver's outside mirror

**CHASSIS AND SUSPENSION**

4-wheel independent sport-tuned suspension with automatic load leveling • Magnasteer variable-assist steering

**DRIVER CONTROLS**

Center console with floor shifter • Steering wheel audio/climate touch controls • Traction control system on/off switch • Dual power outside mirrors

**SEATING AND TRIM**

Contour front bucket seats with 8-way power adjustments\* • Rear bench seat with integrated head restraints and trunk pass-through • Leather-trimmed seating

**COMFORT AND CONVENIENCE**

Dual-zone automatic climate control • AM/FM stereo Dimensional Sound system with CD/cassette player combination • Automatic Electrochromic inside mirror with compass • Retained accessory power

**EXTERIOR**

16-inch aluminum wheels • P225/60R16 performance radial tires

**AVAILABLE FEATURES**

OnStar communications system (dealer installed) • Power sunroof • Chrome wheels • Supercharged 3800 Series II V6 engine

**SPECIFICATIONS**

ENGINE	3800 SERIES II V6	SUPERCHARGED 3800 SERIES II V6
Displacement	3.8 liters (231 cu in)	3.8 liters (231 cu in)
Horsepower	205 @ 5200 rpm	240 @ 5200 rpm
Torque (lb-ft)	230 @ 4000 rpm	280 @ 3600 rpm
Fuel delivery	Sequential port fuel injection	

**EXTERIOR DIMENSIONS**

	EIGHTY EIGHT	LSS
Wheelbase (in)	110.8	110.8
Length (in)	200.4	200.4
Width (in)	74.1	74.1
Height (in)	55.7	55.7
Curb weight (lb)	3455	3547

**INTERIOR DIMENSIONS**

Headroom, front/rear (in)	38.7/38.3	38.7/38.3
Legroom, front/rear (in)	42.5/38.7	42.5/38.7
Shoulder room, front/rear (in)	59.0/58.3	59.0/58.3

**CAPACITIES**

Passenger capacity	6 (5 on LS)	5
Trunk volume (cu ft)	17.9	17.9
Fuel (gal)	18.0	18.0

\* Maintenance needs vary with use and driving conditions. See your owner's manual for more information.  
† LSS available only with bucket seats.

1999 SILHOUETTE



**STANDARD FEATURES**

**SAFETY AND SECURITY**

Next Generation dual frontal air bags • Front seat side-impact air bags • 4-wheel antilock brakes • Automatic programmable power door locks • Sliding door child-security locks • Daytime running lamps with automatic headlamp control • Foglamps • Variable-intermittent front wipers • Rear-window wiper/washer • Foldaway power outside mirrors • Battery-rundown protection

**POWERTRAIN/CHASSIS AND SUSPENSION**

3400 SFI V6 engine with 100,000-mile platinum-tipped spark plugs and 150,000-mile coolant\* • Electronically controlled 4-speed overdrive automatic transmission with 100,000-mile fluid\* • Front-wheel drive • Independent front MacPherson strut/rear twist axle and coil spring suspension • Power rack-and-pinion steering • Power brakes

**DRIVER CONTROLS**

Analog instrument cluster with tachometer and gauges for coolant temperature and fuel level • Trip odometer and low engine coolant and oil indicators • Cruise control • TILT-Wheel adjustable steering column

**SEATING AND TRIM**

Reclining contour front bucket seats with adjustable lumbar support and folding armrest • Cloth-trimmed 7-passenger seating with second-row split-bench seat in GL and GS, and leather-trimmed captain's chairs in GLS and Premiere • Third-row 50/50 split-bench seat • Storage: locking glove box, removable console storage bin, rear cargo-area storage bins, cupholders for all seating positions, and map pockets in front doors and front seat/captain's chair seatbacks • Front-seat and rear cargo-area convenience nets • Passenger assist handles

**COMFORT AND CONVENIENCE**

Air conditioning with particle and odor filtration system • AM/FM stereo with auto-reverse cassette player • Power front side windows with driver's-side auto-down, plus power rear-quarter vent windows • Overhead console with map lights (includes storage areas, driver information center and compass on GS, GLS and Premiere)

**EXTERIOR**

Dual sliding side doors • Halogen headlamps with flash-while-passing feature • Rooftop luggage carrier • Soft-Ray tinted glass with solar-control windshield • Integrated windshield radio antenna • Deep-tinted rear privacy glass

**AVAILABLE FEATURES**

COMFORT AND CONVENIENCE	GL	GS	GLS PREMIERE
Premiere. On-board Entertainment Center: videocassette player with fold-down color monitor for rear passengers	—	—	S
GL Personal Convenience Package: second-row captain's chairs, 6-way power front seats, CD/cassette stereo and remote-control keyless entry	A	—	—
GL Rear Convenience Package: auxiliary rear-seat audio and climate controls	A	—	—
GS Personal Attention Package: second-row captain's chairs, leather-trimmed seating, steering wheel audio touch controls and rear-seat audio controls	—	A	—
Power sliding passenger-side door	A	S	S S
Steering wheel audio touch controls	—	A	S S
Auxiliary rear-seat audio controls	A	A	S S
Auxiliary rear-seat climate controls	A	—	S S

**AVAILABLE FEATURES (CONTINUED)**

SAFETY AND SECURITY	GL	GS	GLS PREMIERE
Remote-control keyless entry with panic button	A	S	S S
Integrated single or dual child safety seat(s)	A	A	—
Electronic full-range traction control system	A	A	S S
OnStar communications system (dealer installed)	A	A	A A

**SEATING AND TRIM**

7-passenger seating with second-row captain's chairs	A	A	S S
8-passenger seating with second-row modular seats	A	A	—
Leather-trimmed seating areas (captain's chairs required)	—	A	S S
6-way power front seats	A	S	S S

**AUDIO SYSTEMS**

Delco ETR AM/FM stereo with integrated CD player	A	A	A	—
Delco ETR AM/FM stereo with cassette/remote CD players	A	A	A	S

**EXTERIOR/CHASSIS**

Gold Package (includes emblems and wheel accents)	A	A	A	A
3,500-lb Towing Package <sup>1</sup> : with engine and transmission coolers, electrical harness and Towing Suspension	A	A	A	A
Touring Suspension: with automatic load leveling, gas-pressurized shock absorbers, stabilizer bars, air inflation kit and touring radial tires	A	A	A	S
S Standard	A Available	—	Not available	—

**SPECIFICATIONS**

**3400 SFI V6 ENGINE**

Displacement	3.4 liters (207 cu in)
Horsepower	185 @ 5200 rpm
Torque (lb-ft)	210 @ 4000 rpm
Fuel delivery	Sequential port fuel injection

**EXTERIOR DIMENSIONS**

	REGULAR	EXTENDED
Wheelbase (in)	112.0	120.0
Length (in)	187.4	201.4
Width (in)	72.2	72.2
Height (in)	67.4	68.1
Curb weight (lb)	3814	3948

**INTERIOR DIMENSIONS**

Headroom, front/middle/rear (in)	39.9/39.3/38.8	39.9/39.3/38.9
Legroom, front/middle/rear (in)	39.9/36.9/34.0	39.9/39.0/36.7
Shoulder room, front/middle/rear (in)	59.8/61.9/60.1	59.8/61.9/59.6

**CAPACITIES**

Passenger capacity	7 or 8	7 or 8
Cargo volume (cu ft)	133.0	155.9
Fuel (gal)	20.0	25.0

\* Maintenance needs vary with use and driving conditions. See your owner's manual for more information.  
† Maximum trailer weight includes driver, one passenger and all required trailering equipment. See the Oldsmobile Trailering Guide for details.

Highlights only – see your Oldsmobile dealer for complete features and availability.

New Silhouette Premiere model available with video entertainment system.  
Highlights only – see your Oldsmobile dealer for complete features and availability.

**STANDARD FEATURES****SAFETY AND SECURITY**

Next Generation dual frontal air bags • 4-wheel antilock brakes • Power door locks • Remote-control keyless entry system with panic button • Vehicle security system • Theft-deterrent system • Daytime running lamps with automatic headlamp control • Heated foldaway power outside mirrors • Foglamps • Variable-intermittent front wipers • Rear window wiper/washer • Battery-rundown protection

**POWERTRAIN**

4.3-liter Vortec V6 engine with 100,000-mile platinum-tipped spark plugs and 150,000-mile coolant\* • Enhanced electronically controlled 4-speed overdrive automatic transmission with 100,000-mile fluid\* • SmartTrak all-wheel drive system with electronic automatic active transfer case and locking rear differential

**CHASSIS AND SUSPENSION**

Fully boxed ladder frame • Independent front suspension with torsion bars, high-pressure gas shock absorbers and stabilizer bar; rear semi-floating axle with two-stage leaf springs, high-pressure gas shock absorbers and stabilizer bar • Variable-ratio power steering • Power 4-wheel disc brakes • 15-inch aluminum wheels • Uniroyal® P235/70R15 blackwall all-season radial tires

**DRIVER CONTROLS**

Analog instrument cluster with tachometer and gauges for oil pressure, coolant temperature, voltage and fuel level • Floor shifter • Cruise control • TILT-Wheel adjustable steering column • Remote liftgate release

**SEATING AND TRIM**

Reclining contour front bucket seats with 2-way power lumbar supports and 8-way power driver's seat • 60/40 rear split-bench folding seat • Leather-trimmed seating areas and steering wheel rim • Storage: front floor console with dual cupholders, overhead console, glove box, front seatback pockets, front and rear door map pockets, and rear door cupholders • Passenger-assist handles

**COMFORT AND CONVENIENCE**

Air conditioning with automatic electronic climate control and rear-seat heat ducts • AM/FM stereo Dimensional Sound system with CD/cassette player combination • Power windows with driver's-side auto-down • Electrochromic inside rearview mirror • Illuminated visor vanity mirrors • Overhead console with HomeLink Universal Transmitter, compass, outside temperature display, trip computer and reading lamps • Retained accessory power

**EXTERIOR**

Halogen headlamps with flash-while-passing feature • Solar-control tinted windshield, plus deep-tinted rear privacy glass • One-piece rear liftgate with separate liftglass • Aero rooftop luggage rack • Body-color bumpers and body side moldings • Underbody-mounted full-size spare tire • Color-keyed accent stripes

**AVAILABLE FEATURES****CONVENIENCE PACKAGE**

8-way power front passenger's seat, memory controls for driver's seat, Electrochromic heated driver's outside mirror, 5,000-pound Towing Package† with platform hitch, and white-letter outline tires. (Features available separately.)

**COMFORT AND CONVENIENCE**

Heated front seats  
Power sunroof with sliding tinted glass panel and sunshade  
BOSE premium audio system  
Console-mounted 6-disc CD changer  
Steering wheel audio touch controls  
HomeLink lighting package (see your dealer)  
OnStar communications system (dealer installed)

**EXTERIOR/POWERTRAIN**

Gold package  
Engine block heater

**SPECIFICATIONS****VORTEC V6 ENGINE**

Displacement	4.3 liters (262 cu in)
Horsepower	190 @ 4400 rpm
Torque (lb-ft)	250 @ 2800 rpm
Fuel delivery	Sequential central port injection

**EXTERIOR DIMENSIONS**

Wheelbase (in)	107.0
Length (in)	181.2
Width (in)	67.8
Height (in)	64.4
Curb weight (lb)	4068
Ground clearance (in)	7.5 (minimum)

**INTERIOR DIMENSIONS**

Headroom, f/r (in)	39.6/38.1
Legroom, f/r (in)	42.4/36.3
Shoulder room, f/r (in)	57.2/57.2

**CAPACITIES**

Passenger capacity	5
Cargo volume, seats down/up (cu ft)	74.1/37.3
Fuel (gal)	18.0

\* Maintenance needs vary with different uses and driving conditions. See your owner's manual for more information.

† Maximum trailer weight includes driver, one passenger and all required trailering equipment. See the Oldsmobile Trailering Guide for details.

**NEED MORE INFORMATION ?**

WWW.OLDSMOBILE.COM OR 1-800-255-OLDS Oldsmobile provides several

ways to help keep you well informed about our vehicles. Call

1-800-255-OLDS (6537), and you can talk to a representative who

will be happy to answer your questions, direct you to your nearest

dealership, or send you one of our brochures. You can also visit our

website at [www.oldsmobile.com](http://www.oldsmobile.com). The brochures and websites provide full-

color photographs and product information to help you make important

decisions regarding the purchase of your next vehicle.



The next best thing to a thorough test drive, our full-color brochures let you experience the style and sophistication of Oldsmobile's 1999 model lineup from the comfort of your home or office. Your Oldsmobile dealer can provide a brochure, or you can order one by calling 1-800-255-OLDS (6537).



Surf the net at your leisure to find the Oldsmobile information you need. Each vehicle has its own address which can be found in the Oldsmobile website at [www.oldsmobile.com](http://www.oldsmobile.com).



**VISIT US AT [WWW.OLDSMOBILE.COM](http://WWW.OLDSMOBILE.COM) OR CALL 1-800-255-OLDS (6537).**