



International ACCO-B Series

1810: 4x2

RATINGS

GROSS VEHICLE MASS (GVM) — tonne (lb.)
GROSS COMBINATION MASS (GCM)

GVM:	STANDARD GVM 12.85 (28 350)	GVM 11.55 (25 000)	GVW 13.90 (30 650)†	GCM:
FRONT AXLE	FA-215 5.45 (12 000)	FA-215 5.45 (12 000)	FA-215 5.45 (12 000)	Standard ... 20.90 (46 000)
Suspension	Std. 5.45 (12 000)	Std. 5.45 (12 000)	Std. 5.45 (12 000)	Varied by
Tyres	9.00 x 20 4.65 12-ply (10 250)	9.00 x 20 4.20 10-ply (9 250)	10.00 x 20 5.58 14-ply (12 300)	Transmission T-451 16.30 (36 000)
Rating	4.65 (10 250)	4.20 (9 250)	5.45 (12 000)	†NAASRA rating
REAR AXLE	RA-186 8.40 (18 500)	RA-186 8.40 (18 500)	RA-186 8.60 (18 960)	
Suspension	Std. 8.40 (18 500)	Std. 8.40 (18 500)	Std. 8.60 (18 960)	
Tyres	9.00 x 20 8.20 12-ply (18 100)	9.00 x 20 7.35 10-ply (16 200)	10.00 x 20 8.64 12-ply (19 050)	
Rating	8.20 (18 100)	7.35 (16 200)	8.60 (18 960)	

STANDARD EQUIPMENT

AXLE, FRONT

FA-215, wide track, 5.45 t (12 000 lb.) capacity.
Forged steel I-beam.

AXLE, REAR

RA-186 8.60 t (18 960 lb.) capacity, two-speed.
Full floating, hardened axle shafts.
Ratio: 6.50/8.86:1 (T-253).
Ratio: 7.17/9.77:1 (T-451).

BRAKES, PARKING

Internal expanding shoe on driveline, 305 x 102 mm (12 x 4 in.) DCM.
Total lining area: 712 cm² (110 sq. in.).

BRAKES, SERVICE

Air over hydraulic, self-adjusting, dual operation with warning light and buzzer.
Dual cylinder, single piston front.
Dual cylinder, double piston rear.
0.21 m³/min. (7½ cu. ft.) air compressor.
Size: 381 x 89 mm (15 x 3½ in.) front,
381 x 152 mm (15 x 6 in.) rear.
Total lining area: 3 942 cm² (611 sq. in.).

CAB

2.18 m (86 in.) width all steel with safety glass windows, laminated windscreen.
Manual tilt.
Door lock on both doors.
Individual driver's seat adjustable fore and aft, with adjustable angle backrest.
Arm rests on doors.
Single passenger seat.
Seat belts (for driver and passenger).
Triple electric two-speed windshield wipers.
Windshield washers.
Dual external rear vision mirrors.
Sun visor (driver's side); ashtrays.
Rubber floor mats with sound-deadening insulation.

Two door courtesy switch controlled internal light.
Fresh-air heater-demister with two-speed fan.
Fresh-air circulation incl. windshield.
Lockable glove-box.
Individual instruments comprising:
fuel level, air pressure, water temperature gauges, speedometer and odometer.
Warning lights for low oil pressure, brake fail, alternator.

CLUTCH

Mechanical control.
330 mm (13 in.) 15 spring, single plate.
Lining area: 1 174 cm² (182 sq. in.).

ELECTRICAL SYSTEM

12 volt.
Circular sealed beam 75/50 watt headlights with front parking lights.
Front directional signals with cab clearance lamps. Reversing lights.
Dual tail/stop/turning signal lamps.
Front and rear flashing hazard lights.
Fuse panel to protect circuits.
61 amp. hr. capacity battery,
negative earth. 55 amp. alternator.

ENGINES

International V-345 eight cylinder petrol.
Gross power: 132 kW (177 BHP) at
Gross torque: 409 Nm (302 lb./ft.) at
2 200 RPM.
5.65 litre (345 cu. in.) displacement;
7.18:1 compression ratio.
Full flow oil filter.
Positive crankcase ventilation with air intake from air cleaner.
Dry element air cleaner with vertical air-intake stack and restriction indicator.
RAC horsepower rating: 48:1.

OR

International V-392 eight cylinder petrol.
Gross power: 158 kW (212 BHP) at
4 000 RPM.

Gross torque: 450 Nm (332 lb./ft.) at
2 600 RPM.
6.39 litre (390.0 cu. in.) displacement;
7.03:1 compression ratio.
Full-flow oil filter, oil cooler.
Positive crankcase ventilation with intake from air-cleaner.
Dry element air cleaner with vertical air intake stack and restriction indicator.
RAC horsepower rating: 54.5.
Horizontal muffler and tailpipe.

FINISH

Electro-phoretic deposited undercoat with acrylic enamel finishing coat.
Interior colour scheme: Grampian Brown.
Cab: Choice of Mt. Newman Red, Mt. Isa Gold, Forrest Beige, Kosciuszko White, Rum Jungle Green, Narrandera Red.
Chassis and Wheels: Black.
Bumper: Silver Metallic.

FRAME

Pressed-steel channel 229 x 76 x 6 mm
(9 x 3 x ¼ in.).
L-shaped reinforcement 216 x 83 x 6 mm
(8½ x 3¼ x ¼ in.).
Combined section modulus: 277 cm³
(16.89 cu. in.).
Formed channel front bumper.
Side mounted tyre carrier.
Wheelbases: 3.43, 4.04, 4.34, 4.80 m.
(135, 159, 171, 189 in.).

FUEL SYSTEM

159 litre (35 gal.) capacity tank, right side.
Mechanical fuel pump.
Paper-element fuel filter.

STEERING

S-44 steering gear.
530 mm (21 in.) diameter four-spoke dished steering wheel, column-mounted self-cancelling turn indicator and hazard light switch.

SUSPENSION

Semi-elliptical leaf springs.

Front: 1.52 m x 75 mm (60 x 3 in.).

Rear: 1.17 m x 75 mm (46 x 3 in.) variable rate, capacity tailored to axle load with 864 x 75 mm (34 x 3 in.) auxiliary.

Double acting hydraulic shock absorbers front.

TRANSMISSION

T-253 5-speed synchromesh.

Ratios: 6.92, 3.98, 2.38, 1.47, 1.00; reverse 6.81:1.

UNIVERSAL JOINTS

Spicer 1480 needle roller bearing.

WHEELS AND TYRES

Single front and dual rear.

Cast spoke 7.00 T rims.

9.00 x 20 12-ply tyres.

Spare rim.

OPTIONAL EQUIPMENT

BRAKES, SERVICE

Air-operated, with spring actuated, piggy back parking brake on rear axle, total parking brake lining area: 2 426 cm² (376 sq. in.).

CAB

Back-panel and rear shelf-lining.

Crew cab.

Bench type passengers' seat.

Sun visor (passengers' side).

FRAME

Rear mounted tyre carrier 4.04 m (159 in.).

WB and up only, with side mounted carrier deleted.

STEERING

Power assisted S-295 steering with 508 mm (20 in.) steering wheel.

TRANSMISSION

T-451 automatic (Allison AT-540).

4-speed, ratios: 6.90/3.45, 2.25, 1.41, 1.00; reverse 10.04/5.02:1 with

(a) Parking brake 254 x 76 mm (10 x 3 in.)

DCM. Total lining area: 446 cm²

(69.1 sq. in.), spring/air actuated.

(b) Transmission oil temperature warning light.

WHEELS AND TYRES

9.00 x 20 - 10-ply tyres.

10.00 x 20 - 14-ply front, 12-ply rear with 7.50 V rims.

SPECIAL EQUIPMENT AVAILABLE

FRAME

3.12 m (123 in.) wheelbases.

Frame reinforcement to 3.12 m (123 in.)

WB as option.

N.B.: All trucks used for arduous rigid operations such as tipper applications must be equipped with frame reinforcement.

Chrome front bumper.

Fifth wheel mounting.

dimensions & mass

ACCO-1810B

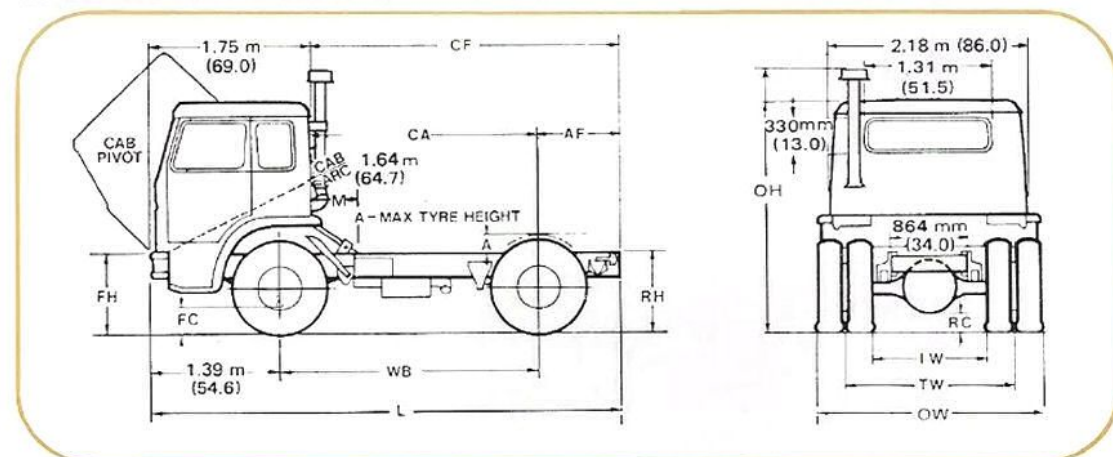

Dimensions, with 9.00 x 20 tyres m (in.)

FH (Frame height) — front axle: 880 mm (34.7)	FC (Ground clearance) — front axle: 295 mm (11.6)	TW (Tread width) — front axle: 2.05 (80.6)
RH (Frame height) — rear axle: 963 mm (37.9)	RC (Ground clearance) — rear axle: 229 mm (9.0)	rear axle: 1.78 (70.0)
empty: 874 mm (34.4)	A (Max. tyre height) — with 9.00 x 20 tyres: 229 mm (9.0)	IW (Inside width) — rear wheels: 1.22 (48.1)
OH (Overall height) — to top of air stack: 2.86 (112.6)	OW (Overall width) — front fenders: 2.44 (96.0)	M (Minimum clearance necessary between back of cab and body at 178 mm (7.0) above side rail): 76 mm (3.0)
to top of cab: 2.48 (97.6)	rear axle: 2.33 (91.9)	

Chassis Dimensions m (in.)

Turning circle m (ft.)

Chassis mass t (lb.)‡

WB	CA	AF	CF	L	To outer edge of tyre track	Front	Rear	Total
3.43 (135)	3.06 (120.6)	0.86 (34.0)	3.93 (154.6)	5.68 (223.6)	14.9 (49)	2.71 (5 980)	1.15 (2 540)	3.86 (8 520)
4.04 (159)	3.67 (144.6)	1.58 (62.0)	5.25 (206.6)	7.00 (275.6)	17.1 (56)	2.70 (5 960)	1.21 (2 670)	3.91 (8 630)
4.34 (171)	3.98 (156.6)	1.58 (62.0)	5.55 (218.6)	7.31 (287.6)	19.7 (65)	2.69 (5 940)	1.25 (2 750)	3.94 (8 690)
4.80 (189)	4.44 (174.6)	2.44 (96.0)	6.87 (270.6)	8.63 (339.6)	22.6 (74)	2.68 (5 920)	1.29 (2 830)	3.97 (8 750)

‡ Wet weight

In order that product improvements may be introduced at any time, specifications are subject to change without notice.

Illustrations may include optional equipment. Metric and Imperial quantities shown are equivalent within the implied accuracy.

International Trucks

YOUR INTERNATIONAL DEALER:

PRICE QUOTED:

INTERNATIONAL HARVESTER AUSTRALIA LIMITED.

A-110-F (Dec., 1977)

IFC
A SPECIAL
BRAND OF
FINANCE