



International ACCO-B Series F3070: 6x4

RATINGS GROSS VEHICLE MASS (GVM) — tonne (lb.)

	STANDARD GVM 20.37 (44 900)		GVM 20.37 (44 900)		GVM 20.87 (46 000)		GVM 20.87 (46 000)		GVM 20.87 (46 000)		GVM 20.87 (46 000)	
FRONT AXLE	FA-215	5.45 (12 000)	FA-215	5.45 (12 000)	FA-215	5.45 (12 000)	FA-215	5.45 (12 000)	FA-215	5.45 (12 000)	FA-215	5.45 (12 000)
Suspension	Std.	5.45 (12 000)	Std.	5.45 (12 000)	Std.	5.45 (12 000)	Std.	5.45 (12 000)	Std.	5.45 (12 000)	Std.	5.45 (12 000)
Tyres	10.00 x 20 12 ply	4.95 (10 900)	10.00 x 20 12 ply	4.95 (10 900)	10.00 x 20 14 ply	5.50 (12 120)	10.00 x 20 14 ply	5.50 (12 120)	11.00 x 20 14 ply	5.97 (13 160)	11.00 x 20 14 ply	5.97 (13 160)
Rating		4.95 (10 900)		4.95 (10 900)		5.45 (12 000)		5.45 (12 000)		5.45 (12 000)		5.45 (12 000)
REAR AXLE	RA-333	17.30 (38 000)	RA-328	15.42 (34 000)	RA-333	17.30 (38 000)	RA-328	15.42 (34 000)	RA-333	17.30 (38 000)	RA-328	15.42 (34 000)
Suspension	Std.	15.42 (34 000)	Std.	15.42 (34 000)	Std.	15.42 (34 000)	Std.	15.42 (34 000)	Std.	15.42 (34 000)	Std.	15.42 (34 000)
Tyres	10.00 x 20 12 ply	17.28 (30 100)	10.00 x 20 12 ply	17.28 (30 100)	10.00 x 20 14 ply	19.24 (42 400)	10.00 x 20 14 ply	19.24 (42 400)	11.00 x 20 14 ply	20.96 (46 200)	11.00 x 20 14 ply	20.96 (46 200)
Rating		15.42 (34 000)		15.42 (34 000)		15.42 (34 000)		15.42 (34 000)		15.42 (34 000)		15.42 (34 000)

GROSS COMBINATION MASS (GCM) tonne (lb.)

Standard: 38.00 (83 400)

STANDARD EQUIPMENT

AXLE, FRONT

FA-215 5.45 t (12 000 lb.) capacity.
Forged steel I-beam.

AXLE, REAR

RA-333 17.30 t (38 000 lb.) capacity,
single reduction.
Ratio: 5.29:1.

BRAKES, PARKING

Spring-actuated, piggy-back on rear axles.
Total lining area: 5 678 cm² (880 sq. in.)
with 16 800 cm³ (1 025 cu. in.) reservoir
for emergency release.

BRAKES, SERVICE

Air operated with 0.374 m³/min (13.2 cu. ft.)
compressor, with low air pressure
warning light and buzzer.
Size: 381 x 89 mm (15 x 3 1/2 in.) front;
381 x 178 mm (15 x 7 in.) rear.
Total lining area: 7 033 cm² (1 090 sq. in.).
39 670 cm³ (2 421 cu. in.) air reservoir.

BRAKES, TRAILER

Semi-trailer air connections with breakaway
and hand control valves.

CAB

2.18 m (86 in.) width all steel with safety
glass windows.
Manual tilt.
Laminated windscreen.
Door lock on both doors.
Derby 5000 fully adjustable driver's seat.
Adjustable fore and aft with height and
inclination adjustment. Weight and
suspension adjustments are controlled by
springs and hydraulic shock absorber.
Single passenger seat.
Seat belts (for driver and passenger).

CAB (Continued)

Triple electric two-speed windshield wipers.
Windshield washers.
Dual external rear vision mirrors.
Arm rests on doors.
Sun visor (driver's side); ashtrays.
Rubber floor mats with sound-deadening
insulation.
Two-door courtesy switch controlled
internal light.
Fresh air heater-demister with two speed
fan.
Fresh-air circulation including windshield.
Lockable glove-box.
Individual instruments comprising volt-
meter, fuel level, oil pressure, air
pressure, oil and water temperature
gauges, speedometer, odometer and
tachometer.
Brake fail warning light.
Back-panel and rear shelf lining.
Power divider lock indicator light.

CLUTCH

Mechanical control.
356 mm (14 in.) twin plate.
Total lining area: 2 730 cm² (423 sq. in.).

ELECTRICAL SYSTEM

12 volt with 75 amp. alternator.
320 amp. hr. capacity, batteries, negative
to earth.
Circular quartz halogen 60/55 watt
headlights with front parking lights.
Front directional signals with cab clearance
lamps. Reversing lights.
Dual tail/stop/turning signal lamps.
Front and rear flashing hazard signals.
Fuse panel to protect circuits.
Dual air horns.

ENGINE

Cummins V-903 (320).

ENGINE (Continued)

Max. gross power: 239 kW (320 BHP) at
2 600 RPM.
Max. gross torque: 1 003 Nm (740 lb./ft.)
at 1 800 RPM.
14.8 litre (903 cu. in.) displacement:
16.5:1 compression ratio.
Full-flow oil filter and cooler.
RAC horsepower rating: 96.7.
'Spin-on' corrosion resister.
Vertical muffler and tailpipe.
Large capacity remote-mounted by-pass
oil filter.
400 mm (16 in.) Cyclopac dry-element
air cleaner with vertical air-intake stack
and restriction indicator.

FINISH

Electro-phoretic deposited undercoat with
acrylic enamel finishing coat.
Interior colour scheme: Grampian Brown.
Cab: Choice of Mt. Newman Red, Mt. Isa
Gold, Forrest Beige, Kosciuszko White,
Rum Jungle Green, Narrandera Red.
Chassis and wheels: Red.
Bumper: Silver metallic.

FRAME

Flange head bolted construction.
Pressed steel channel, 229 x 76 x 6 mm
(9 x 3 x 1/4 in.) with 241 x 83 x 6 mm
(9 1/2 x 3 1/4 x 1/4 in.) channel.
reinforcement.
Section modulus: 316 cm³ (19.26 cu. in.).
Formed channel front bumper.
Wheelbases: 3.61 m, 4.65 m (142 in., 183 in.).

FUEL SYSTEM

Dual tanks. Left — 227 litre (50 gal.);
Right — 391 litre (86 gal.).
Mechanical fuel pump.
Paper-element fuel filter, 'spin-on' type,
frame mounted.

STEERING

S-295 (Sheppard 392) power assisted steering gear.
508 mm (20 in.) diameter four spoke dished steering wheel, column mounted self cancelling turn indicator and hazard light switch.

SUSPENSION, FRONT

Semi-elliptical leaf springs, 1.52 m x 75 mm (60 x 3 in.)
Telescopic shock absorbers.

SUSPENSION, REAR

Hendrickson RTE 340.
Walking beam suspension, 1.27 m (50 in.) steel beams with 50/50 load distribution 15.40 t (34 000 lb.) at ground.
Torque arms with rubber bushings.
Extended leaf steel springs.

TRANSMISSION

T-471 (RTF-9509A) twin-countershaft Roadranger, 9 speed direct constant mesh.
Ratios: 11.83, 7.90, 5.79, 4.32, 3.20, 2.47, 1.81, 1.35, 1.00; reverse 12.38, 3.87:1.

UNIVERSAL JOINTS

Spicer 1710 needle roller bearing.

WHEELS AND TYRES

Single front and dual rear.
Cast spoke, 7.50 V rims.
10.00 x 20 12 ply tyres.
Spare rim.

OPTIONAL EQUIPMENT**AXLE, REAR**

RA-333 17.30 t (38 000 lb.) capacity.
Single reduction.
Ratio: 5.83:1.

CAB

Bench type passengers' seat.
Sun visor (passengers' side).

ENGINE:

Jacobs engine
brake attachment.

TRANSMISSION

T-218 (RTF-915) twin-countershaft Roadranger, 15 speed direct constant mesh, single stick control with range shift air valve with engine brake attachment.

Ratios: 12.00, 9.42, 8.05, 7.45, 6.30, 5.90, 4.99, 4.78, 3.95, 3.20, 2.51, 1.97, 1.56, 1.24, 1.00; reverse 13.03, 8.73, 2.73:1.

WHEELS AND TYRES

10.00 x 20 14 ply tyres.
11.00 x 20 14 ply tyres.

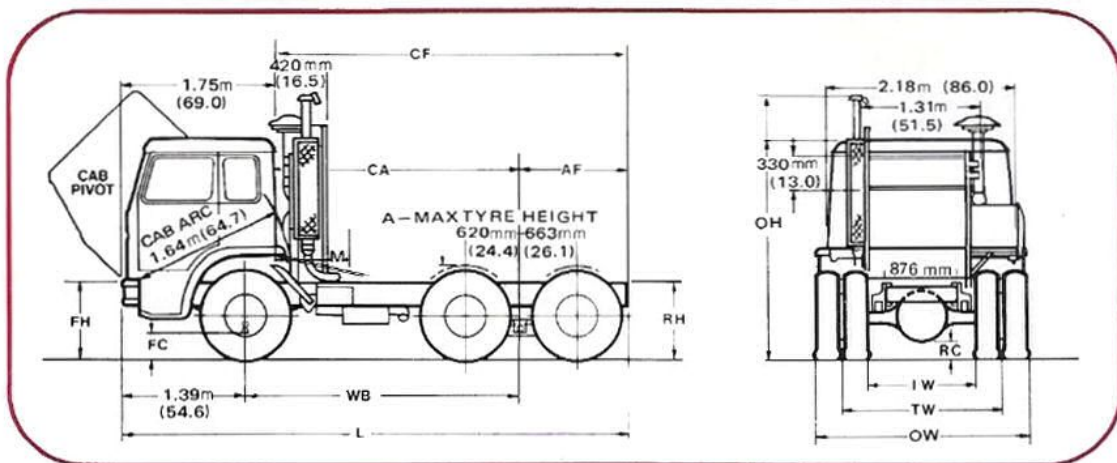
dimensions & mass**ACCO F-3070B****Dimensions, with 10.00 x 20 tyres m (in.)**

(FH) Frame height— front axle— empty: 980 mm (38.6) loaded: 937 mm (36.9)	(RC) Ground clearance — rear axle: 286 mm (11.25)	(TW) Tread width — front axle: 2.03 (80.0) rear axle: 1.83 (71.9)
	(OW) Overall width — front fenders: 2.44 (96.0) rear axle: 2.46 (96.8)	(A) Max. tyre height — with 10.00 x 20 tyres: 211 mm (8.3)
(RH) Frame height — rear bogie: empty: 1.01 (39.8) loaded: 978 mm (38.5)	(OH) Overall height — to top of exhaust: 3.34 (131.4) to top of cab: 2.66 (104.7)	
	(FC) Ground clearance — front axle: 267 mm (10.5)	(IW) Inside width — rear wheels: 1.19 (47.0)

Chassis Dimensions m (in.)**Turning Circle m (ft.)****Chassis mass t (lb.)†**

WB	CA	AF	CF	L	To outer edge of tyre track	Front	Rear	Total
3.61 (142)	3.24 (127.6)	1.32 (52.0)	4.56 (179.6)	6.31 (248.6)	15.6 (51)	3.98 (8 760)	3.34 (7 350)	7.32 (16 110)
4.65 (183)	4.28 (168.6)	2.58 (102.0)	6.87 (270.6)	8.63 (339.6)	20.1 (66)	3.96 (8 750)	3.56 (7 830)	7.52 (16 580)

† Wet weight.

In order that product improvements may be introduced at any time, specifications are subject to change without notice.

Illustrations may include optional equipment. Metric and Imperial quantities shown are equivalent within the implied accuracy.

International Trucks

YOUR INTERNATIONAL DEALER:

PRICE QUOTED:

INTERNATIONAL HARVESTER AUSTRALIA LIMITED.

A-125-B (Dec. 1977)

IHC
A SPECIAL
BRAND OF
FINANCE