



International ACCO-B Series 1950: 4x2

RATINGS

GROSS VEHICLE MASS (GVM) —tonne (lb.)
GROSS COMBINATION MASS (GCM)

GVM:	STANDARD GVM 12.85 (28 320)	GVM 13.90†	GCM:
FRONT AXLE	FA-215 5.45 (12 000)	FA-215 5.45 (12 000)	Standard 24.00 (53 000)
Suspension	Std. 5.45 (12 000)	Std. 5.45 (12 000)	†NAASRA rating
Tyres	9.00 x 20 4.65 12-ply (10 250)	10.00 x 20 5.58 14-ply (12 300)	
Rating	4.65 (10 250)	5.45 (12 000)	
REAR AXLE	RA-60 8.60 (18 960)	RA-60 8.60 (18 960)	
Suspension	Std. 8.60 (18 960)	Std. 8.60 (18 960)	
Tyres	9.00 x 20 8.20 12-ply (18 100)	10.00 x 20 8.65 12-ply (19 100)	
Rating	8.20 (18 100)	8.60 (18 960)	

STANDARD EQUIPMENT

AXLE, FRONT

FA-215 5.45 t (12 000 lb.) capacity.
Forged steel I-beam.

AXLE, REAR

RA-60 8.60 (18 960 lb.) capacity, single
speed.
Ratio: 6.16:1

BRAKES, PARKING

Spring actuated, piggy-back on rear axle.
Total lining area: 2 839 cm² (440 sq. in.),
with 11 800 cm³ (720 cu. in.) reservoir for
emergency release.

BRAKES, SERVICE

Air operated with 0.34 m³/min. (12 cu. ft.)
compressor, with low air pressure warning
light and buzzer.
Size: 381 x 89 mm (15 x 3 1/2 in.) front;
381 x 178 mm (15 x 7 in.) air dual
(fail safe) rear.
Total lining area: 4 194 cm² (650 sq. in.)
39 670 cm³ (2 421 cu. in.) air reservoir.

CAB

2.18 m (86 in.) width all steel with safety
glass windows, laminated windscreen.
Manual tilt.
Door lock on both doors.
Derby 5000 fully adjustable driver's seat.
Adjustable fore and aft with height and
inclination adjustment. Weight and
suspension adjustments are controlled by
springs and hydraulic shock absorber.
Single passenger seat.
Seat belts (for driver and passenger).
Triple electric two-speed windshield wipers.
Windshield washers.
Dual external rear vision mirrors.
Sun visor (driver's side); ashtrays.
Rubber floor mats with sound-deadening
insulation.
Two door courtesy switch controlled internal
light.

Arm rests on doors.

Fresh air heater-demister with two speed fan.
Fresh-air circulation incl. windshield.
Lockable glove-box.
Individual instruments comprising volt-
meter, fuel level, oil pressure, air
pressure, water temperature gauges,
speedometer, odometer and tachometer.
Warning lights for brake fail, alternator.

CLUTCH

Lipe Rollway heavy-duty 356 mm (14 in.),
18 springs.
Ceramic button.
Mechanical control.

ELECTRICAL SYSTEM

12 volt with 55 amp. alternator.
183 amp. hr. capacity batteries, negative
to earth.
Circular quartz halogen 60/55 watt
headlights with front parking lights.
Front directional signals, with cab clearance
lamps. Reversing lights.
Dual tail/stop/turning signal lamps.
Front and rear flashing hazard lights.
Fuse panel to protect circuits.

ENGINE

International D-170 eight-cylinder Diesel.
Max. gross power: 127 kW at 3 000 RPM.
Max. gross torque: 460 Nm at 1 600 RPM.
9.0 litre displacement; 17:1 compression
ratio.
RAC horsepower rating 64.8.
Horizontal muffler and vertical tailpipe.
Full-flow oil filter, oil cooler.
356 mm (14 in.) dry-element air cleaner
direct mounted with restriction indicator.
Vertical air-intake stack.
Rating correct to SAE Standard J270.

FINISH

Electro-phoretic deposited undercoat with
acrylic enamel finishing coat.
Interior colour scheme: Grampian Brown.
Cab: Choice of Mt. Newman Red, Kosciuszko
White, Rum Jungle Green, Narrandera
Red, Hamersley Brown.
Chassis and wheels: Red.
Bumper: Silver metallic.

FRAME

Pressed steel channel 229 x 76 x 6 mm
(9 x 3 x 1/4 in.) with L-shaped
reinforcement.
216 x 83 x 6 mm (8 1/2 x 3 1/4 x 1/4 in.).
Combined section modulus: 277 cm³
(16.89 cu. in.).
Formed channel front bumper.
Wheelbase: 3.12, 3.43 m (123, 135 in.).

FUEL SYSTEM

227 litre (50 gal.) capacity tank, right side.
Electrical fuel pump.
Paper-element fuel filter, 'spin-on' type,
frame mounted.

STEERING

S-295 Power-assisted steering gear.
508 mm (20 in.) diameter four-spoke dished
steering wheel, column-mounted, self-
cancelling turn indicator and hazard
light switch.

SUSPENSION

Semi-elliptical leaf springs.
Front: 1.52 m x 75 mm (60 x 3 in.).
Rear: 1.17 m x 75 mm (46 x 3 in.) variable
rate, capacity tailored to axle load,
with 864 x 75 mm (34 x 3 in.) auxiliary.
Double acting hydraulic shock absorbers
front.

TRANSMISSION

T-448 (RT 610) twin-countershaft Road-ranger, 10-speed direct, constant mesh, with countershaft brake.

Ratios: 9.00, 7.02, 5.48, 4.26, 3.43, 2.62, 2.05, 1.60, 1.24, 1.00; reverse 9.50, 2.77:1.

UNIVERSAL JOINTS

Spicer 1700 needle roller bearing.

WHEELS AND TYRES

Single front and dual rear.

Cast spoke, 7.00 T rims.

9.00 x 20 - 12-ply tyres.

Spare rim.

OPTIONAL EQUIPMENT**CAB**

Back panel and rear shelf lining.

Bench type passengers' seat.

Sun visor (passengers' side).

BRAKES, TRAILER

Semi-trailer air connections with breakaway and hand control valves.

ENGINE

Large capacity remote mounted by-pass oil filter.

FUEL SYSTEM

Dual tanks, 227 litre (50 gal.).

STEERING

S-44 manual steering, with 530 mm (21 in.) steering wheel.

TRANSMISSION

T-465 automatic (Allison MT-650) 5-speed constant mesh, spur type planetary.

Ratios: 8.04, 3.58, 2.09, 1.39, 1.00; reverse 5.67:1.

With —

(a) 6.8 : 1 axle ratio.

(b) Spicer 1600 universal joints.

(c) Transmission oil temp. warning light.

WHEELS AND TYRES

10.00 x 20 - 14-ply tyres with 7.50 V rims, front.
10.00 x 20 - 12-ply tyres with 7.50 V rims, rear.

SPECIFIED ATTACHMENTS**ELECTRICAL SYSTEM**

Dual air horns.

SPECIAL EQUIPMENT AVAILABLE**FRAME**

4.04, 4.34 m (159, 171 in.) wheelbase with L-shape reinforcement.

Rear-mounted tyre carrier to 4.04, 4.34 m (159, 171 in.) WB as option.

Fifth wheel mounting.

Chrome front bumper.

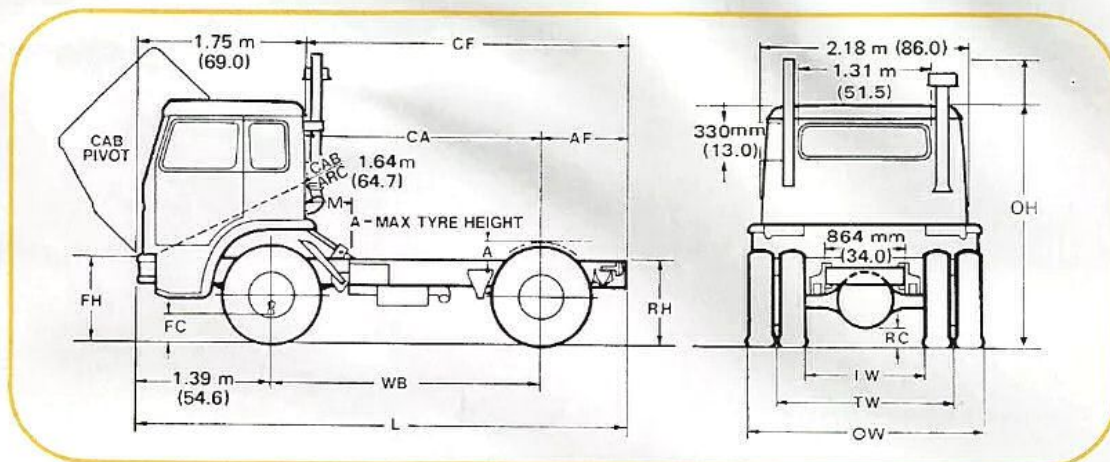
**ACCO - 1950B****Dimensions, with 9.00 x 20 tyres m (in.)**

FH (Frame height) — front axle: 880 mm (34.7)	RC (Ground clearance) — rear axle: 229 mm (9.0)	TW (Tread width) — front axle: 2.05 (80.6) rear axle: 1.78 (70.0)
RH (Frame height) — rear axle: empty: 963 mm (37.9) loaded: 874 mm (34.4)	OW (Overall width) — front fenders: 2.44 (96.0) rear axle: 2.35 (92.4)	IW (Inside width) — rear wheels: 1.21 (47.6)
FC (Ground clearance) — front axle: 295 mm (11.6)	OH (Overall height) — to top of exhaust 3.16 (124.4) to top of cab: 2.56 (101.0)	A (Max. tyre height) — with 9.00 x 20 tyres: 229 mm (9.00)
		M (Minimum clearance necessary between back of cab and body at 178 mm (7.0) above siderail): 457 mm (18.0)

Chassis Dimensions m (in.)**Turning circle m (ft.)*****Chassis mass t (lb.)‡**

WB	CA	AF	CF	L	To outer edge of tyre track	Front	Rear	Total
3.12 (123)	2.76 (108.6)	864 mm (34.0)	3.62 (142.6)	5.38 (211.6)	13.1 (43)	3.17 (7 000)	1.36 (3 000)	4.53 (10 000)
3.43 (135)	3.06 (120.6)	864 mm (34.0)	3.93 (154.6)	5.68 (223.6)	14.3 (47)	3.16 (6 970)	1.45 (3 200)	4.61 (10 170)

* Estimates only ‡ Wet weight

IMPORTANT

Illustrations, information and specifications presented and referred to herein were correct at the time this publication was approved for printing. ■ Metric and Imperial quantities shown are equivalent within the implied accuracy. ■ International Harvester Australia Limited reserves the right, subject to any statutory enactment of Australia and/or a State or Territory thereof, and/or the regulations of any competent authority which may apply from time to time at their or its discretion, and without notice, to discontinue or change the specification or design of the products referred to herein and any options therefore at any time without incurring any liability whatsoever to any purchaser thereof. ■ The availability at any particular time of any of the products or items of standard optional or available equipment referred to, described or illustrated in this specification leaflet will be dependent upon the local and/or overseas supply situation prevailing at that time. ■ You should always consult your IH Dealer, Distributor or Company Branch to ensure you obtain the latest information on models, specifications, features, availability and prices.

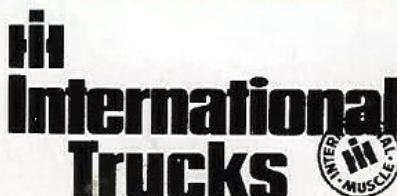

YOUR INTERNATIONAL DEALER:

PRICE QUOTED:

INTERNATIONAL HARVESTER AUSTRALIA LIMITED.

A-99-G (Nov., 1978)

